

NOTICE OF MINERAL TITLE APPLICATIONS OVER ABORIGINAL LAND

MINERAL TITLES ACT 2010 SECTION 71

Objections/Submissions to Mineral Title applications (s71 [3])

The landowner(s) of land in respect of which the following applications are made may lodge an objection to the grant of the application; any other persons may lodge a submission. Objections and submissions must be lodged in writing to the Department of Industry, Tourism and Trade, GPO Box 4550, DARWIN NT 0801 or emailed to titles.info@nt.gov.au. Objections and submissions can also be lodged at Centrepont Building, 48-50 Smith Street, Darwin, within 30 days from the relevant Notification Date, which is set out below.

Exploration Licence 33834 sought by WA1 RESOURCES LTD, ACN 646 878 631 over an area of 250 Blocks (801 km²) depicted below for a term of 6 years, within the TURNERS DOME locality.

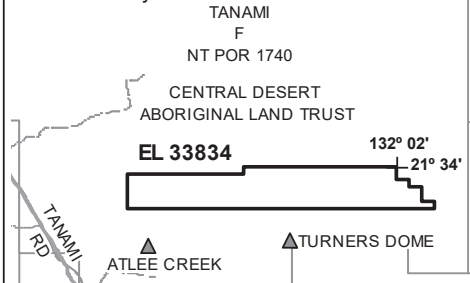

Not To Scale NMIG Map Sheet No: 5254

Exploration Licence 33836 sought by WA1 RESOURCES LTD, ACN 646 878 631 over an area of 250 Blocks (786 km²) depicted below for a term of 6 years, within the TURNERS DOME locality.

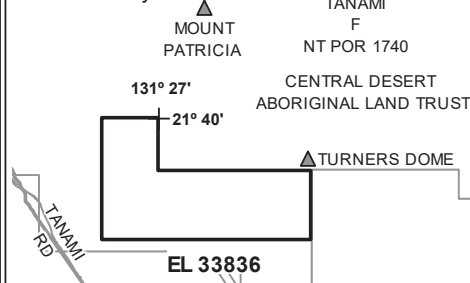

Not To Scale NMIG Map Sheet No: 5254

Exploration Licence 33837 sought by WA1 RESOURCES LTD, ACN 646 878 631 over an area of 250 Blocks (739 km²) depicted below for a term of 6 years, within the TURNERS DOME locality.

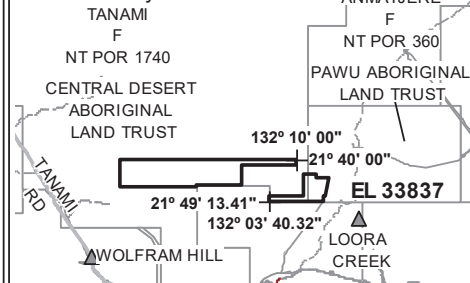

Not To Scale NMIG Map Sheet No: 5254

Exploration Licence 33838 sought by WA1 RESOURCES LTD, ACN 646 878 631 over an area of 71 Blocks (212 km²) depicted below for a term of 6 years, within the TURNERS DOME locality.

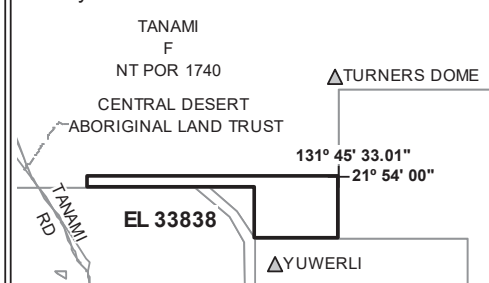

Not To Scale NMIG Map Sheet No: 5254

Exploration Licence 33839 sought by WA1 RESOURCES LTD, ACN 646 878 631 over an area of 52 Blocks (158 km²) depicted below for a term of 6 years, within the CAREY locality.

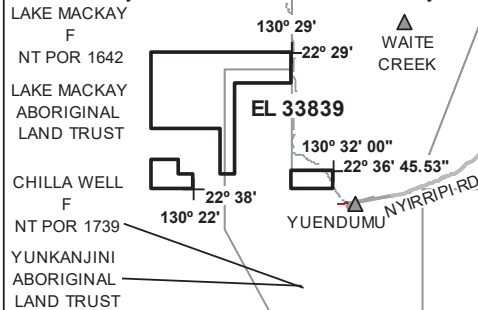

Not To Scale NMIG Map Sheet No: 4952

Exploration Licence 33840 sought by WA1 RESOURCES LTD, ACN 646 878 631 over an area of 163 Blocks (474 km²) depicted below for a term of 6 years, within the VAUGHAN locality.

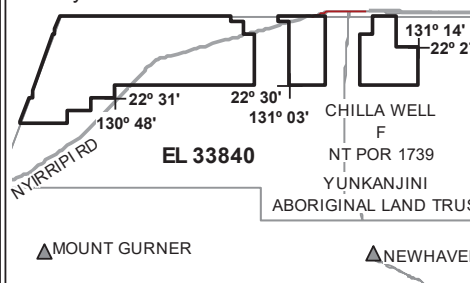

Not To Scale NMIG Map Sheet No: 5053

Exploration Licence 33841 sought by WA1 RESOURCES LTD, ACN 646 878 631 over an area of 19 Blocks (52 km²) depicted below for a term of 6 years, within the YUENDUMU locality.

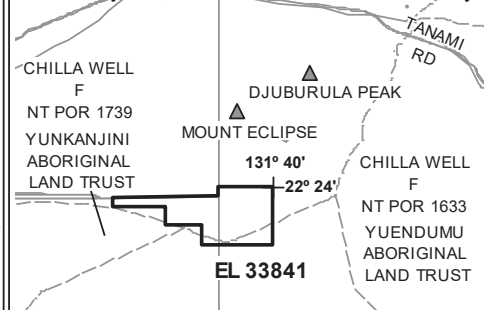

Not To Scale NMIG Map Sheet No: 5253

Exploration Licence 33842 sought by WA1 RESOURCES LTD, ACN 646 878 631 over an area of 24 Blocks (77 km²) depicted below for a term of 6 years, within the SIDDELEY locality.

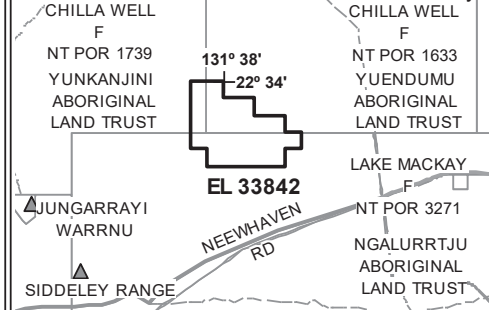

Not To Scale NMIG Map Sheet No: 5252

Notification Date: 29 May 2024