

NOTICE OF PROPOSED GRANT OF AN EXTRACTIVE MINERAL LEASE

NATIVE TITLE ACT 1993 (CTH) SECTION 29

The Honourable Nicole Manison MLA, the Northern Territory Minister for Mining and Industry, C/- Department of Industry, Tourism and Trade, GPO Box 4550 DARWIN NT 0801, hereby gives notice in accordance with section 29 of the *Native Title Act 1993* (Commonwealth) of her intent to do an act(s) namely to grant the following extractive mineral lease application.

The application to which this notice applies:

Extractive Mineral Lease 32614 sought by CENTRAL MINING & EXPLORATION SERVICES PTY LTD, ACN 144 703 168 over an area of 98 Hectares depicted below for a term of 10 years, within the JERVOIS RANGE locality.

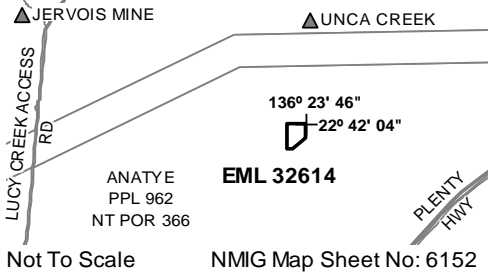

Nature of act(s): The grant of an extractive mineral lease under the *Mineral Titles Act 2010* authorises the holder to extract or remove (whether by quarrying or other means) from, on or below the natural surface of the land, extractive mineral(s) for a term not exceeding 10 years and to seek renewal(s). The term for which it is intended to grant the extractive mineral lease/s referred to in this notice commences from the date of grant. Further information about the act may be obtained from the Department of Industry, Tourism and Trade, GPO Box 4550, Darwin NT 0801 or Centrepoint Building 48-50 Smith Street Darwin NT 0800, telephone (08) 8999 5213.

Native Title Parties: Any person who is, or becomes a "native title party" within the meaning of the *Native Title Act 1993* is entitled to the negotiation and/or procedural rights

provided in Part 2, Division 3, Subdivision P of the *Native Title Act 1993*. Under section 30 of the *Native Title Act 1993*, persons have until 3 months after the notification day to take certain steps to become native title parties in relation to this notice. Enquiries concerning becoming a native title party should be directed to the National Native Title Tribunal, GPO Box 9973, Brisbane QLD 4001, or telephone (07) 3307 5000.

Notification Day: 5 May 2021