



### Plant Health Act

#### DECLARATION OF QUARANTINE PLACE FOR BANANA AND PLANTAIN PLANTS - MILIKAPITI I, MALCOLM LAURENCE ANDERSON, Acting Chief Inspector of Plant Health:

- (a) under section 18(1) of the *Plant Health Act*, declare the following areas to be a quarantine place for the control of the declared pest Banana Freckle *Phyllosticta cavendishii* (the **declared pest**):
  - (i) NT Portion 7087(A) (including Lot 107) as shown on Survey Plan S2010/230 in Schedule 1 (the **restricted area**);
  - (ii) the area described in Schedule 2 and depicted shaded in dark grey on the diagram in Schedule 3 (the **control area**); and
- (b) declare the quarantine place for the purposes mentioned in section 18(2)(b) and (c)(i) to (iv) and (d) of the *Act*; and
- (c) specify that the following prohibitions apply to the whole of the quarantine place:
  - (i) the entry into the quarantine place of any declared host plant for the declared pest (a **host plant**) is prohibited;
  - (ii) the movement of any host plant, or material from a host plant, within the quarantine place is prohibited;
  - (iii) the removal of any host plant, or material from a host plant, from the quarantine place (other

- than removal under the direction of the Chief Inspector) is prohibited;
- (iv) the propagation or planting of host plants within the quarantine place is prohibited; and
- (d) specify that the reason for the decision to make this declaration is because the quarantine place is affected by the declared pest; and
- (e) specify that a person whose interests are or might be affected by the decision has a right to apply under section 58 of the *Act* for reconsideration of the decision; and
- (f) under section 19(2) of the *Act*, for a period of 12 months from the date of this instrument, require the owners of host plants in the restricted area to dispose of the host plants as soon as practicable by:
  - (i) permitting access to the Chief Inspector, inspectors of plant health and other persons authorised for the purpose by the Chief Inspector; and
  - (ii) permitting persons mentioned in subparagraph (i) to:
    - (A) remove all host plants from the property; and
    - (B) treat all remaining stumps with glyphosate as per the Australian Pesticides and Veterinary Medicines Authority permit number PER 14512.

Dated 4th February, 2014.

M. L. ANDERSON  
Acting Chief Inspector  
of Plant Health

### SCHEDULE 1

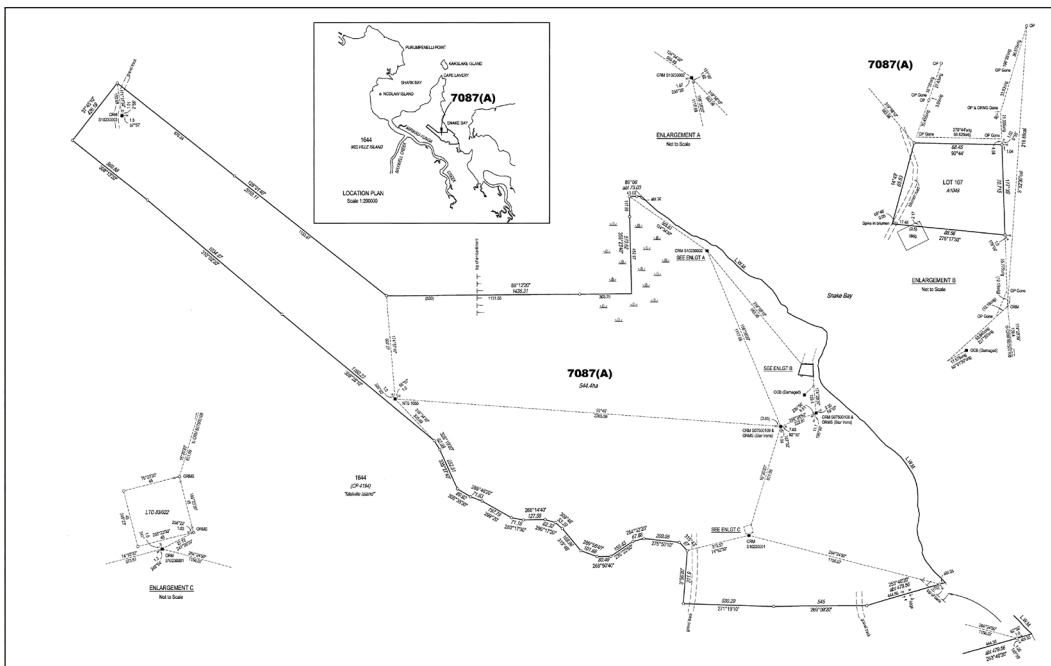

SCHEDULE 2

Control Area

That area bounded by imaginary lines commencing from a point at Timrambu (latitude South 11 degrees 26.575 minutes, longitude East 130 degrees 41.115 minutes) heading in a south-westerly direction to a point at Sabu Landing (latitude South 11 degrees 27 minutes, longitude East 130 degrees 39.894 minutes); then in a north-westerly direction following Mirikauyunga Creek (locally known as Shark Creek) to the mouth of the creek; then heading north-east contiguous with the coast to the most north-east point of Cape Lavery (locally known as Karlake); then heading south-east contiguous with the coast to the point of commencement.

SCHEDULE 3

Tiwi Island RA & CA - 3/02/2014

