

BREWER ESTATE BUILDING AREA (BBASP 002)

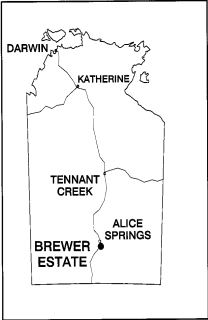
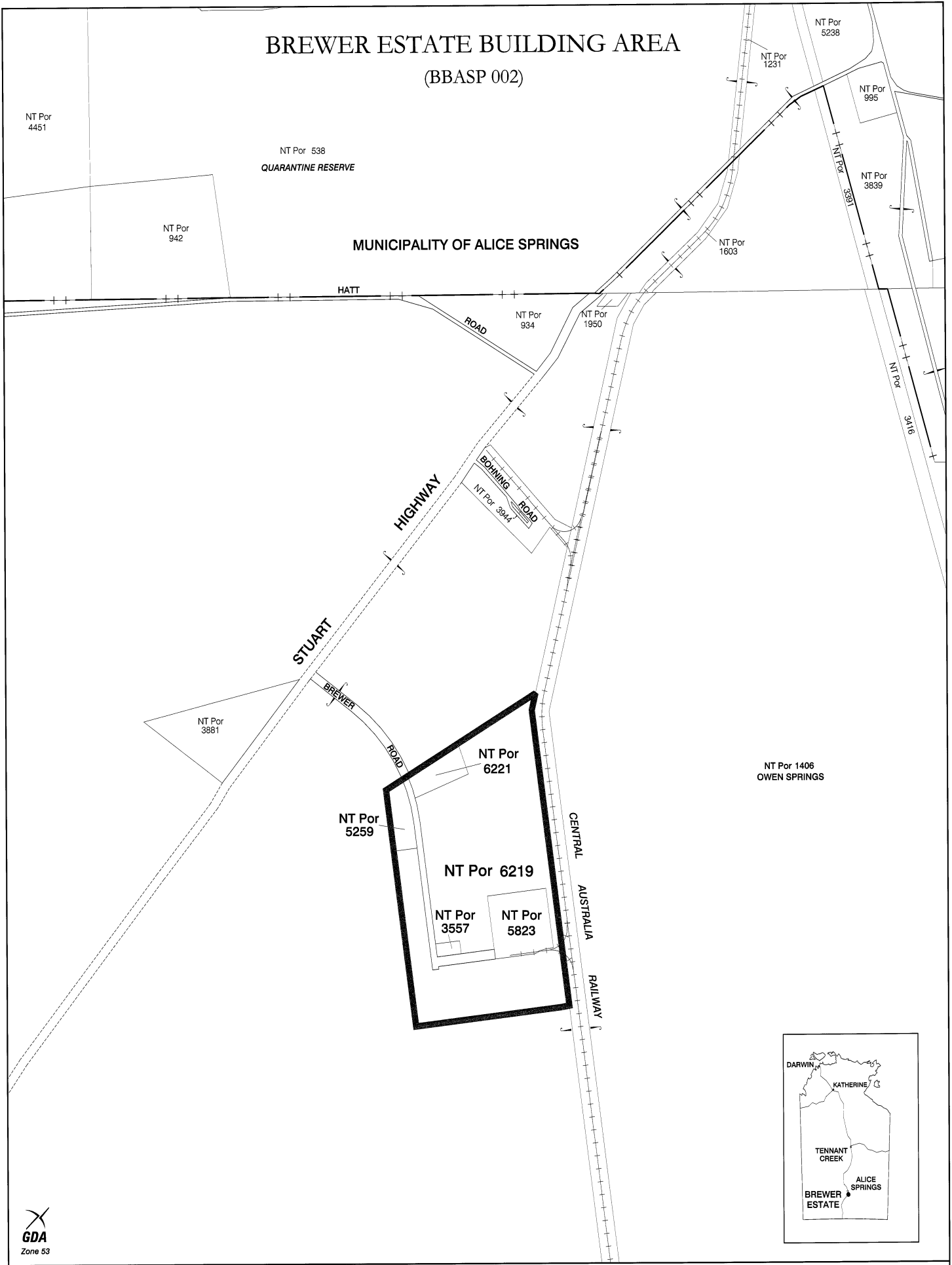

Municipal Boundary — + + —
Northern Territory Government Gazette No. G10, 15 March, 2000

Building Area Boundary —————

The Northern Territory of Australia does not warrant that the product or any part of it is correct or complete and will not be liable for any loss, damage or injury suffered by any person as a result of its inaccuracy or incompleteness. You are encouraged to notify any error or omission in the material by calling 8999 7595.



[Signature]
 Minister for Lands and Planning
 Date: 10/9/04

Northern Territory Government
 Department of Infrastructure, Planning and Environment

Cadastre Current as at 14/07/2004 Source: Northern Territory DCDB

CP 4958