

NOTICE OF MINERAL TITLE APPLICATIONS

MINERAL TITLES ACT 2010 SECTION 71

Objections or Submissions to mineral title applications (s71 [3])

The landowner(s) of land in respect of which the following applications are made may lodge an objection to the grant of the application; any other persons may lodge a submission. Objections and submissions must be lodged in writing to the Department of Industry, Tourism and Trade, GPO Box 4550, DARWIN NT 0801 or emailed to titles.info@nt.gov.au. Objections and submissions can also be lodged at Centrepont Building, 48-50 Smith Street, Darwin, within 30 days from the relevant Notification Date, which is set out below.

Extractive Mineral Exploration Licence 32371 sought by EAST ARM CIVIL PTY LTD, ACN 073 382 251 over an area of 4 Blocks (14 km²) depicted below for a term of 2 years, within the MALLAPUNYAH locality.

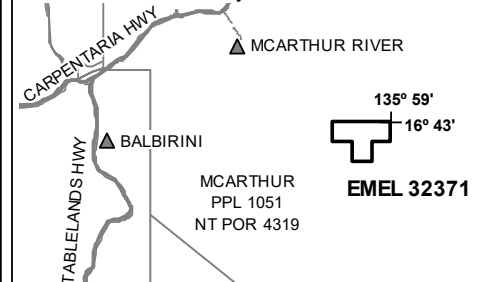

Not To Scale NMIG Map Sheet No: 6064

Extractive Mineral Exploration Licence 32372 sought by EAST ARM CIVIL PTY LTD, ACN 073 382 251 over an area of 4 Blocks (14 km²) depicted below for a term of 2 years, within the MALLAPUNYAH locality.

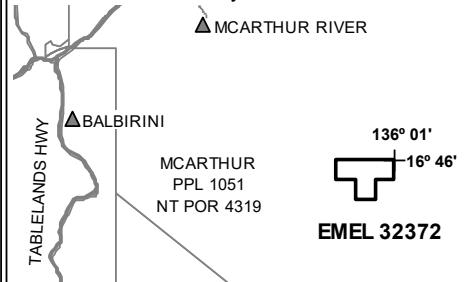

Not To Scale NMIG Map Sheet No: 6064

Extractive Mineral Exploration Licence 32373 sought by EAST ARM CIVIL PTY LTD, ACN 073 382 251 over an area of 4 Blocks (14 km²) depicted below for a term of 2 years, within the GLYDE locality.

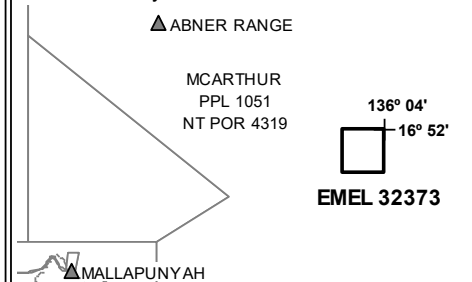

Not To Scale NMIG Map Sheet No: 6164

Extractive Mineral Permit 32358 sought by MOUSELLIS & SONS PTY LTD, ACN 009 654 791 over an area of 61 Hectares depicted below for a term of 5 years, within the MARY RIVER locality.

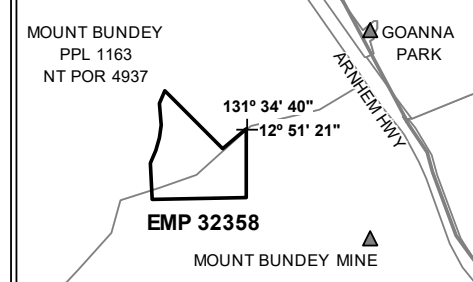

Not To Scale NMIG Map Sheet No: 5272

Extractive Mineral Permit 32367 sought by SAGE CONSTRUCTIONS PTY LTD, ACN 009 654 648 over an area of 88 Hectares depicted below for a term of 5 years, within the KOOLPINYAH locality.

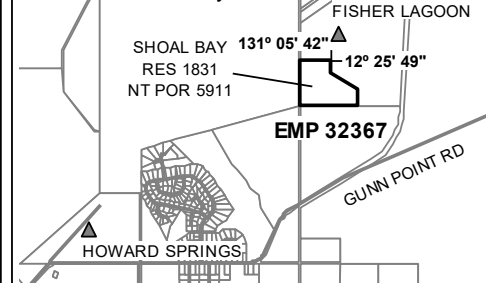

Not To Scale NMIG Map Sheet No: 5173

Extractive Mineral Permit 32368 sought by SAGE CONSTRUCTIONS PTY LTD, ACN 009 654 648 over an area of 71 Hectares depicted below for a term of 5 years, within the KOOLPINYAH locality.

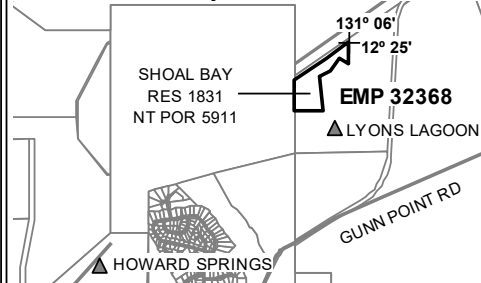

Not To Scale NMIG Map Sheet No: 5173

Extractive Mineral Exploration Licence 32252 sought by YEBNA QUARRIES HOLDINGS PTY LTD, ACN 600 183 248 over an area of 4 Blocks (12 km²) depicted below for a term of 2 years, within the KOOLPINYAH locality.

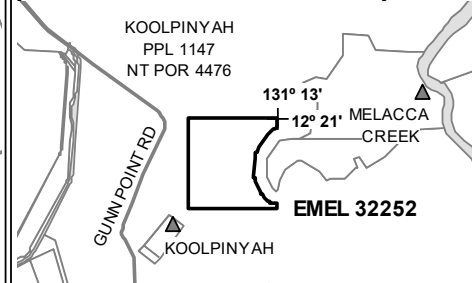

Not To Scale NMIG Map Sheet No: 5173

Extractive Mineral Exploration Licence 32253 sought by YEBNA QUARRIES HOLDINGS PTY LTD, ACN 600 183 248 over an area of 4 Blocks (9 km²) depicted below for a term of 2 years, within the KOOLPINYAH locality.

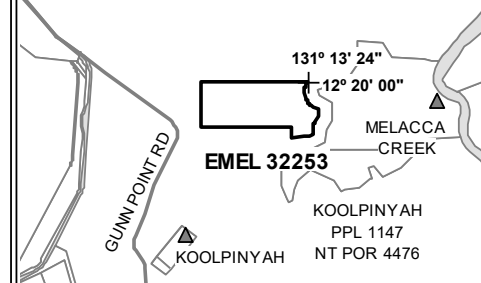

Not To Scale NMIG Map Sheet No: 5173

Notification Date: 30 September 2020