

Made under the *Petroleum (Submerged Lands) Act 1967* of the Commonwealth of Australia.

D. ERRINGTON
DELEGATE OF
THE DESIGNATED
AUTHORITY
FOR THE PRINCIPAL
NORTHERN TERRITORY
PSL AREA

Defence 17½ Mile Camp at the place described in Schedule 1 and depicted in the diagram in Schedule 2, to be a heritage place.

Dated 31st August, 2007.

D. P. LAWRIE
Minister for
Natural Resources,
Environment and Heritage

4/50

Petroleum (Submerged Lands) Act 1967

COMMONWEALTH OF AUSTRALIA

NOTICE OF GRANT OF RENEWAL OF RETENTION LEASE FOR NT/RL2

A renewal of retention lease NT/RL2 has been granted to:

Woodside Energy Ltd
Shell Development (Australia) Pty Ltd
ConocoPhillips STL Pty Ltd
Osaka Gas Australia Pty Ltd

in respect of the blocks described hereunder, to have effect for a period of five years from and including 19 November 2007.

DESCRIPTION OF BLOCKS

Map Sheet SC52 MELVILLE ISLAND

Block Numbers:

1248 part 1320 part 1392 part

Assessed to contain three (3) part blocks.

Dated 3rd December, 2007.

Made under the *Petroleum (Submerged Lands) Act 1967* of the Commonwealth of Australia.

E. ERRINGTON
DELEGATE OF
THE DESIGNATED
AUTHORITY
FOR THE PRINCIPAL
NORTHERN TERRITORY
PSL AREA

5/50

Planning Act

ERRATUM

NOTICE OF AMENDMENT OF NT PLANNING SCHEME AMENDMENT NO. 34

DARWIN LOCALITY

Notice No. 9/46 in *Gazette* No. G46, 14 November 2007 read incorrectly.

It read:

I, DELIA PHOEBE the Minister for Planning and Lands

It should have read:

I, DELIA PHOEBE LAWRIE, the Minister for Planning and Lands

6/50

Heritage Conservation Act

DECLARATION OF HERITAGE PLACE

DEFENCE 17½ MILE CAMP

I, DELIA PHOEBE LAWRIE, the Minister for Natural Resources, Environment and Heritage, under section 26(1)(a) of the *Heritage Conservation Act*, declare the place known as

SCHEDULE 1

All that parcel of land in the Town of Palmerston in the Northern Territory of Australia containing an area of 11.5 hectares more or less, being that part of Lot 4250 designated Lot 9784(A) and bounded by lines described as follows:

Commencing at a point on the northern boundary of Lambrick Avenue situated at map grid co-ordinate 718 460 metres East; thence north-westerly, generally north-easterly and south-easterly by straight lines connecting in succession map grid co-ordinates 718 392 metres East 8 617 713 metres North, 718 415 metres East 8 617 794 metres North, 718 479 metres East 8 617 840 metres North and 718 584 metres East 8 617 773 metres North; thence north-easterly through map grid co-ordinate 718 669 metres East 8 617 823 metres North to the south-western boundary of the Stuart Highway; thence south-easterly by part of a south-western boundary of the said Highway and generally south-westerly by south-eastern boundaries of Avenue to a point situated at map grid co-ordinate 8 617 496 metres North; thence south-westerly to the point of commencement, all co-ordinates quoted here-in being Map Grid of Australia Zone 52.

SCHEDULE 2

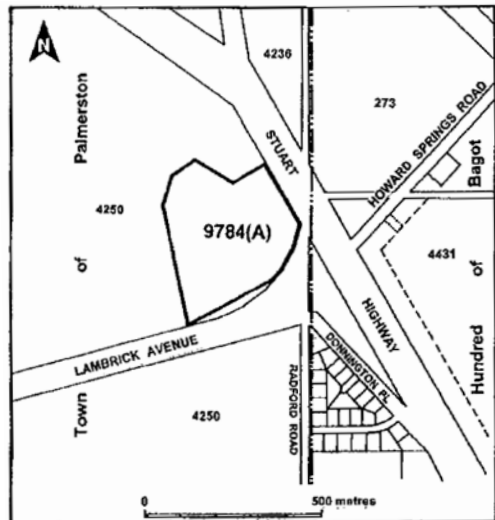

7/50

Place Names Act

ERRATUM

NAMING OF PLACE

Notice No. 9/48 in *Gazette* No. G48, 28 November 2007 read incorrectly.

It read: On page 3 in the first paragraph and page 4 in the second paragraph as Henning Close.

It should have read: Henning Madsen Close.

8/50