

NORTHERN TERRITORY OF AUSTRALIA

Planning Act

AMENDMENT TO NT PLANNING SCHEME

I, GERALD FRANCIS MCCARTHY the Minister for Lands and Planning, under section 13(2)(a) of the *Planning Act*, amend the NT Planning Scheme by making the amendment, specified in the Schedule.

Dated 20 July 2012

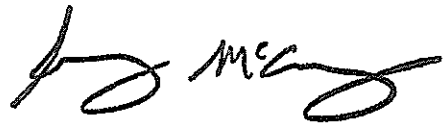

Minister for Lands and Planning

SCHEDULE

AMENDMENT TO NT PLANNING SCHEME

AMENDMENT No. 240

1. Citation

This amendment to the NT Planning Scheme may be cited as Amendment No. 240.

2. Definition

In this amendment –

"amending map" means the map, signed by the Minister for Lands and Planning and marked "NT Planning Scheme Amendment No. 240", deposited in the office of the Department of Lands and Planning, Darwin;

"zoning map" means the zoning map within the meaning of the NT Planning Scheme.

3. Amendment of Zoning Map

The NT Planning Scheme is amended by amending the zoning map relating to Darwin to the extent of its inconsistency with the amending map in respect of the area of land shown on the amending map bounded by a thick black line and lettered SC which is part Lot 5621 (proposed Lot 8426) Town of Darwin (Stuart Highway, Stuart Park).

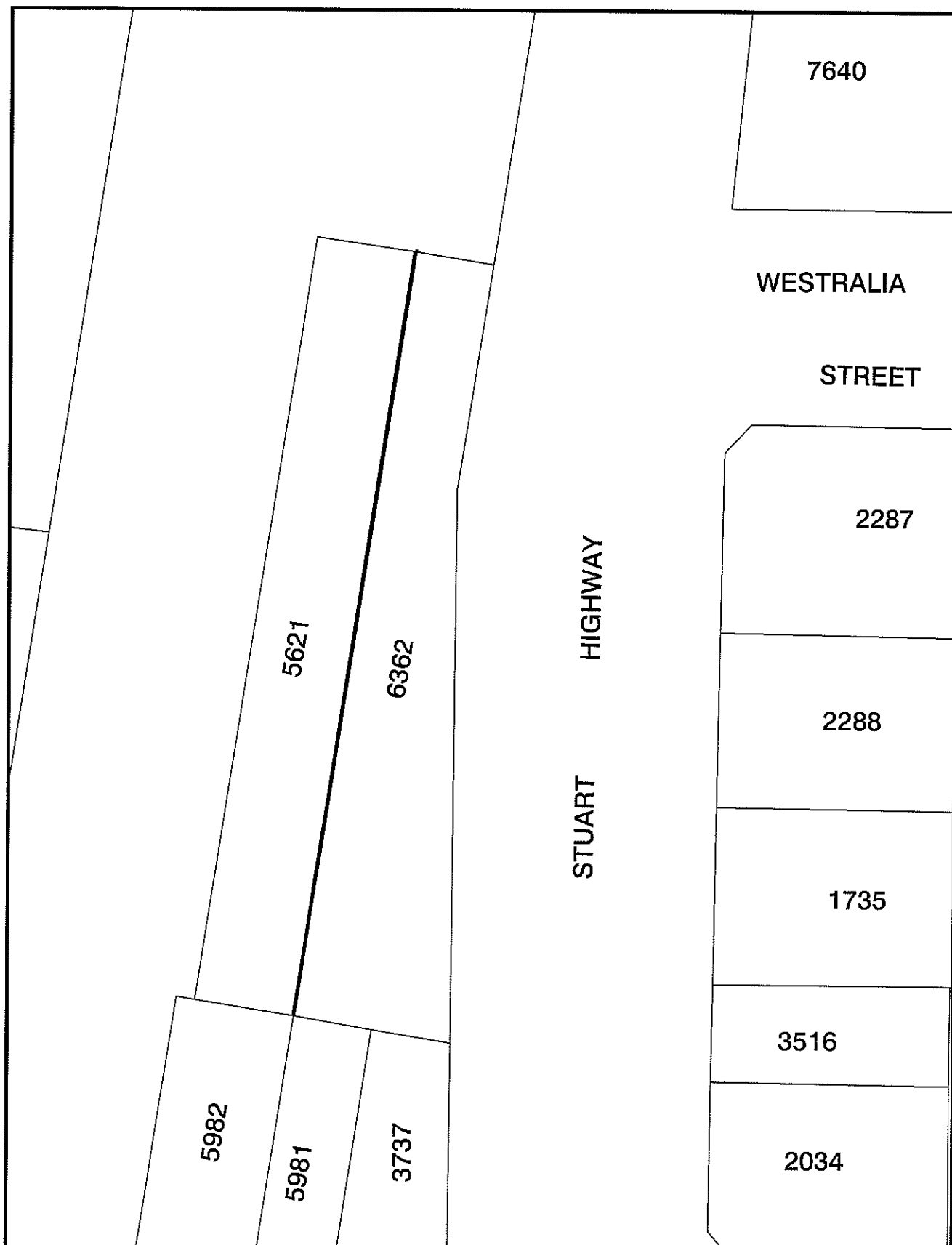

NT PLANNING SCHEME
AMENDMENT No. 240
PART LOT 5621 TOWN OF DARWIN



Northern
Territory
Government

Department of Lands & Planning



Scale 1:1000 @ A4



MINISTER FOR LANDS AND PLANNING

Date 20/7/12

File No.

Date: 2-Jul-12

Drawing Name: PSA Prop lot 8426 Darwin.dgn

NORTHERN TERRITORY OF AUSTRALIA

Planning Act

**NOTICE OF MAKING OF AMENDMENT TO NT PLANNING SCHEME
AMENDMENT No. 240**

DARWIN LOCALITY

I, GERALD FRANCIS MCCARTHY, the Minister for Lands and Planning, under section 28(1) of the *Planning Act*, give notice that –

- (a) I have, under section 13(2)(a) of the Act, amended the NT Planning Scheme by rezoning part Lot 5621 Town of Darwin (Stuart Highway, Stuart Park) from Zone PM (Proposed Main Road) to Zone SC (Service Commercial); and
- (b) copies of the amendment, (Amendment No. 240), are available from the Offices of the Department of Lands and Planning, Ground Floor, 16 Parap Road, Arnhemica House, Parap.

Dated 20 July 2012

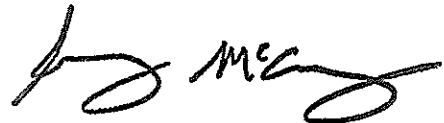

Minister for Lands and Planning

NORTHERN TERRITORY OF AUSTRALIA

Planning Act
Section 29

Reasons for Decision

NORTHERN TERRITORY PLANNING SCHEME
AMENDMENT No. 240

Amendment No. 240 relates to part Lot 5621 (proposed Lot 8426) Town of Darwin in the suburb of Stuart Park.

A building that was recently constructed on Lot 6362 Town of Darwin in Stuart Park encroached onto the Crown land (Lot 5621) to the rear of the site. The NT Government has agreed to the sale of the land, an area of approximately six square metres (proposed Lot 8426). Lot 6362 is zoned SC (Service Commercial) and the land to the rear, Lot 5621 is zoned PM (Proposed Main Road).

Development Permit DP12/0169 dated 23 March 2012 approved the subdivision of part Lot 5621 (proposed Lot 8426) Town of Darwin and the consolidation of that land with Lot 6362 Town of Darwin.

Lot 6362 Town of Darwin is zoned SC (Service Commercial). Rezoning of proposed Lot 8426 from Zone PM (Proposed Main Road) to Zone SC (Service Commercial) means there is a single zoning over the development.



GERALD FRANCIS MCCARTHY
Minister for Lands and Planning

20/7 /2012