

Alice Springs South of MacDonnell Ranges (Arumbera Industrial) Area Plan

Version	Amendment No.	Date Published	Details
1	133 (NTPS 2007)	12.5.2010	Introduction of the Alice Springs South of Macdonnell Ranges (Arumbera Industrial) Area Plan
2	213	7.3.2012	Omits and replaces the map to the Area Plan
3	3 (NTPS 2020)	30.10.2020	Minor alterations for consistency with the NT Planning Scheme 2020

Future development within the area is to:

1. Provide for a range of lot sizes, catering for a broad range of industrial uses including warehousing and light and general industry.
2. Ensure industrial development creates areas which are pleasant to work in, safe and efficient in terms of transportation, land utilisation and service distribution.
3. Allow commercial or retail development only where it relates to the use of land within the zone for industrial purposes.
4. Facilitate access internally and to arterial road and rail network by:
 - (a) providing extra wide roads for easy access for heavy vehicles;
 - (b) identifying two alignments for access off the Stuart Highway; and
 - (c) catering for a rail spur line.
5. Preserve and integrate areas of environmental and cultural heritage significance by implementing appropriate environmental and engineering measures, including but not limited to landscaped buffer zones and the application of principles of water sensitive urban design.
6. Redirect industrial activities that need to be isolated from other urban uses (such as offensive or hazardous industries) to Brewer Estate.

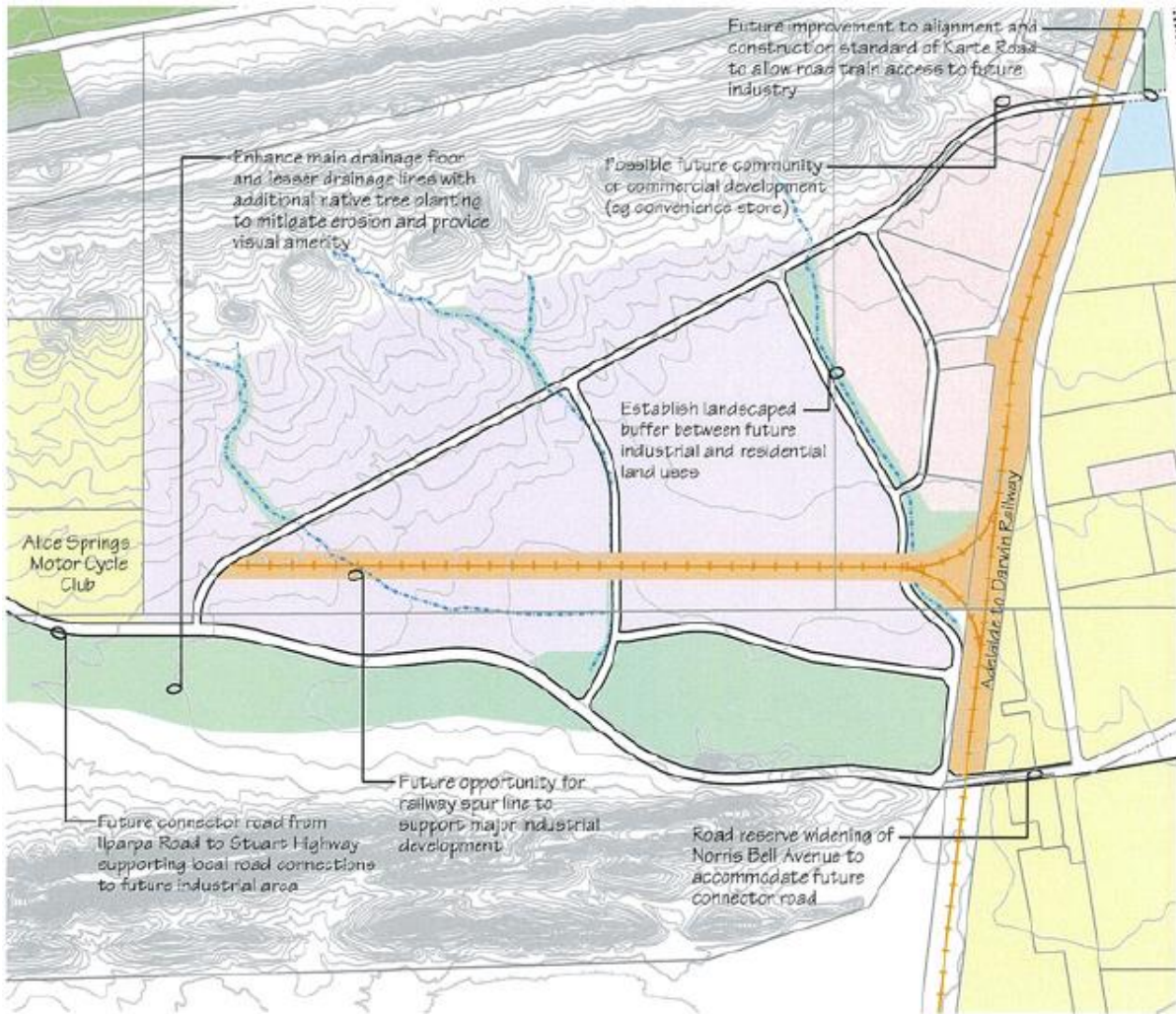





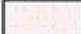

New industrial area

Proximity to the new residential area of Kilgariff and existing rural residential areas support this precinct as a future major employment area. Upgraded road access to the Stuart Highway will be essential both for heavy industry traffic, service vehicles and public transport. The road network will need to provide direct access to the future industrial lots and efficient internal circulation.

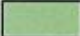
Detailed design of future development will need to minimise the risks of soil erosion and incorporate the principles of Water Sensitive Urban Design. Measures such as utilising the existing drainage floor to retain stormwater should be considered.

Legend

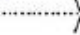
- | | | | |
|---|-------------------------|---|----------------------------------|
|  | Residential Use Area |  | Utilities Purposes Area |
|  | Community Use Area |  | Rural Living, Agriculture |
|  | Service Commercial Area |  | Industry |
|  | Open Space Area |  | Cycleway and Pedestrian Corridor |

Alice Springs
Arumbera Area Plan
New Industrial Area

October 2011



Arumbera Area Plan.dgn