

NOTICE OF MINERAL TITLE APPLICATIONS OVER ABORIGINAL LAND

MINERAL TITLES ACT 2010 SECTION 71

Objections/Submissions to Mineral Title applications (s71 [3])

The landowner(s) of land in respect of which the following applications are made may lodge an objection to the grant of the application; any other persons may lodge a submission. Objections and submissions must be lodged in writing to the Department of Industry, Tourism and Trade, GPO Box 4550, DARWIN NT 0801 or emailed to titles.info@nt.gov.au. Objections and submissions can also be lodged at Centrepont Building, 48-50 Smith Street, Darwin, within 30 days from the relevant Notification Date, which is set out below.

Exploration Licence 33922 sought by THE AUSTRALIAN MINING SERVICE PTY LTD, ACN 625 506 247 over an area of 250 Blocks (792 km²) depicted below for a term of 6 years, within the EGERTON locality.

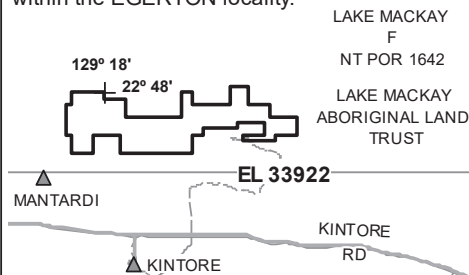

Not To Scale NMIG Map Sheet No: 4752

Exploration Licence 33923 sought by THE AUSTRALIAN MINING SERVICE PTY LTD, ACN 625 506 247 over an area of 250 Blocks (798 km²) depicted below for a term of 6 years, within the SYDNEY MARGARET locality.

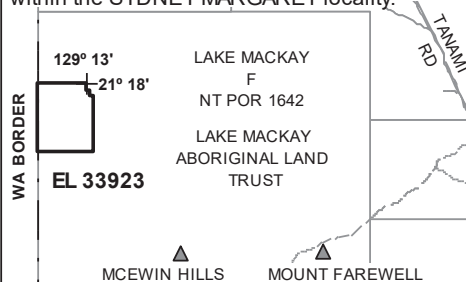

Not To Scale NMIG Map Sheet No: 4755

Exploration Licence 33924 sought by THE AUSTRALIAN MINING SERVICE PTY LTD, ACN 625 506 247 over an area of 236 Blocks (756 km²) depicted below for a term of 6 years, within the SYDNEY MARGARET locality.

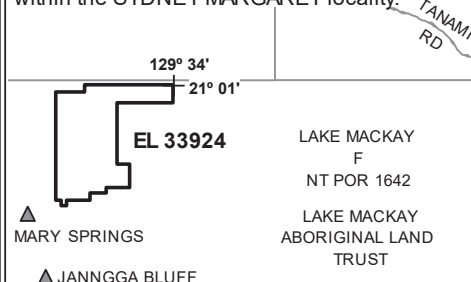

Not To Scale NMIG Map Sheet No: 4755

Exploration Licence 33925 sought by THE AUSTRALIAN MINING SERVICE PTY LTD, ACN 625 506 247 over an area of 213 Blocks (684 km²) depicted below for a term of 6 years, within the PEDESTAL HILLS locality.

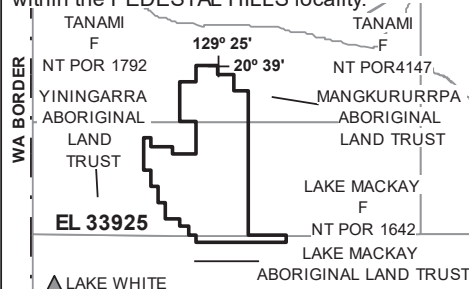

Not To Scale NMIG Map Sheet No: 4756

Exploration Licence 33926 sought by THE AUSTRALIAN MINING SERVICE PTY LTD, ACN 625 506 247 over an area of 82 Blocks (263 km²) depicted below for a term of 6 years, within the WICKHAM locality.

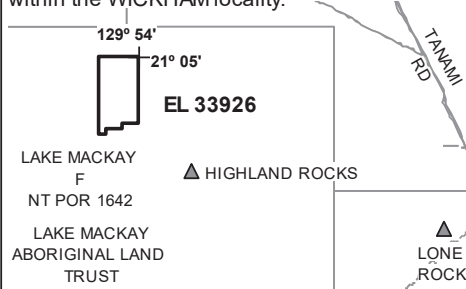

Not To Scale NMIG Map Sheet No: 4855

Exploration Licence 33927 sought by THE AUSTRALIAN MINING SERVICE PTY LTD, ACN 625 506 247 over an area of 250 Blocks (761 km²) depicted below for a term of 6 years, within the GURNER locality.

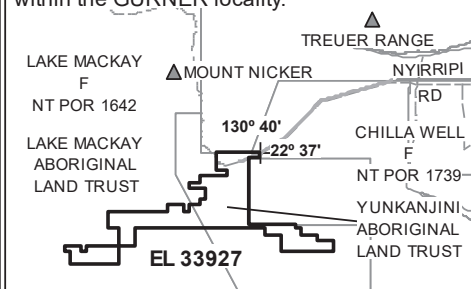

Not To Scale NMIG Map Sheet No: 5052

Exploration Licence 33928 sought by THE AUSTRALIAN MINING SERVICE PTY LTD, ACN 625 506 247 over an area of 34 Blocks (108 km²) depicted below for a term of 6 years, within the EHRENBERG locality.

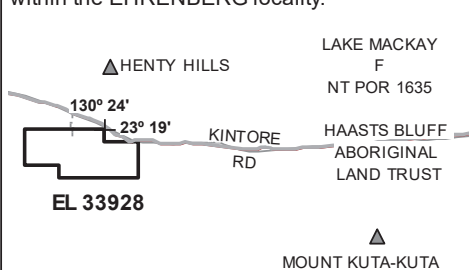

Not To Scale NMIG Map Sheet No: 4951

Exploration Licence 33929 sought by THE AUSTRALIAN MINING SERVICE PTY LTD, ACN 625 506 247 over an area of 82 Blocks (258 km²) depicted below for a term of 6 years, within the GLEN HELEN locality.

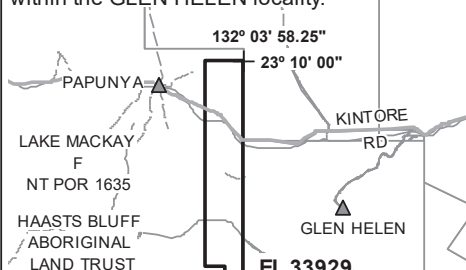

Not To Scale NMIG Map Sheet No: 5351

Exploration Licence 33930 sought by THE AUSTRALIAN MINING SERVICE PTY LTD, ACN 625 506 247 over an area of 35 Blocks (107 km²) depicted below for a term of 6 years, within the SIDDELEY locality.

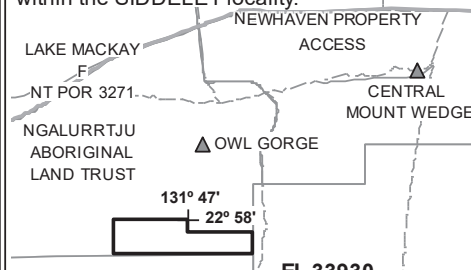

Not To Scale NMIG Map Sheet No: 5252

Notification Date: 21 August 2024