

**PASTORAL LAND BOARD**

*Pastoral Land Act – section 38(1)(h)*

**CONSENT TO CLEAR PASTORAL LAND**

**PERMIT NUMBER: PLC09/1**

**DESCRIPTION OF LAND THE SUBJECT OF THE PERMIT**

Station Name: Neutral Junction Station  
Pastoral Lease No: PPL969  
NT Portion: 3375  
Northern Alice Springs Pastoral District

**DETAILS OF APPROVED CLEARING**

The Pastoral Land Board on 6 August 2009 granted consent to the clearing of approximately 82 hectares of native vegetation for irrigated pastures for hay production, in accordance with the attached schedule of conditions and the endorsed clearing plan Drawing No. 09/969/1.

**REASONS FOR DECISION**

1. The application is in accordance with the Land Clearing Guidelines 2002.
2. Soil types in the areas approved for clearing are suitable for clearing and establishment of irrigated pastures.
3. The resource management plan submitted with the application addresses relevant resource management issues.

**PERIOD OF THE PERMIT**

This permit will lapse if clearing has not commenced within 3 years and/or has not been completed within 5 years of the date of this permit; and the lessee will need to seek an extension of time from the Pastoral Land Board to complete the clearing.

**APPEAL**

Under section 119 of the *Pastoral Land Act*, a pastoral lessee who is dissatisfied with a decision of the Pastoral Land Board may appeal to the Pastoral Land Appeal Tribunal against the decision of the Board. Appeals may be lodged with the Registrar of the Appeal Tribunal within 28 days of notification of the decision of the Board.



A D Young  
Chairman  
Pastoral Land Board

## CONSENT TO CLEAR PASTORAL LAND

### PERMIT NUMBER: PLC09/1 SCHEDULE OF CONDITIONS

1. Prior to commencement of clearing, the lessee shall obtain a Groundwater Extraction Licence as required under the Water Act, and shall comply with all licence requirements to the satisfaction of the Controller of Water Resources.
2. Clearing carried out under this permit shall be in accordance with the drawing endorsed as forming part of this permit, to the satisfaction of the Chairman, Pastoral Land Board.
3. All clearing is to be carried out on the contour.
4. Areas of rock outcrops and stone arrangements are not to be cleared and are to be avoided during clearing procedures and any construction works carried out.
5. Clearing and ongoing resource management shall be in accordance with the Resource Management Plan endorsed as forming part of this permit, to the satisfaction of the Chairman, Pastoral Land Board.
6. The Pastoral Land Board is to be notified before the commencement of clearing and on completion of the clearing development.
7. In the event the irrigated pasture project is decommissioned or abandoned, the lessee shall prepare and implement a native vegetation rehabilitation plan to the satisfaction of the Chairman, Pastoral Land Board.

#### NOTES

1. The Aboriginal Areas Protection Authority recommends that the pastoral lessee obtain an Authority Certificate to indemnify against prosecution under the *Aboriginal Sacred Sites Act 1989*.
2. The permit holder is advised that there are statutory obligations under *the Weeds Management Act 2001* to take all practical measures to manage weeds on the property. For advice on weed management please contact the Regional Weeds Officer, Natural Resources, Environment, the Arts and Sport on telephone 8951 9210.
3. Fire prevention measures are to be implemented in accordance with the requirements of the *Bushfires Act*. Permits must be obtained from the Regional Fire Control Officer of the Department of Natural Resources, Environment, the Arts and Sport (telephone 89523066) before ignition of any felled timber in this area.
4. The *Heritage Conservation Act 1991* protects archaeological places and objects, regardless of the level of documentation that the Office of Environment and Heritage has of such sites. It is an offence to undertake work on a place or object without the consent of the Minister for Environment and Heritage.
5. It is the responsibility of the pastoral lessee to refer the proposed development to the Commonwealth Department of the Environment and Heritage under the *Environment Protection and Biodiversity Conservation Act* should they believe the proposed development may have a significant impact on a matter of national environmental significance as outlined in that legislation.



A D Young  
Chairman  
Pastoral Land Board

NORTHERN TERRITORY OF AUSTRALIA

Approved Form 15 (20/07/2009)

**LICENCE TO TAKE GROUNDWATER**

Pursuant to Section 60 of the *Water Act*

**Licence No. WDP5012**

<b>Licencee:</b>	Charles Frith		
<b>Address:</b>	"Glen Arden" Roma QLD 4455		
<b>Expiry Date:</b>	01/09/2019	<b>Water Control District (if applicable):</b>	Western Davenport
<b>Groundwater Resource:</b>	Lake Surprise Sandstone	<b>Trading Zone:</b>	N/A
<b>Registered Bore Number(s):</b>	TBA		
<b>Property(s) on which water to be used:</b>	NTP3375 Neutral Junction		
<b>Beneficial Use</b>	<b>Security Level</b>	<b>Maximum Water Entitlement (ML/Yr)</b>	<b>Trading Available?</b>
Agriculture	N/A	1200	None

Terms

1. The licence holder may take or use up to, but no more than the maximum quantity of Groundwater stated as the maximum water entitlement, subject to annual water allocation announcements, if applicable, and the terms and conditions as stated on this licence:
2. The licence is valid until the expiry date stated on the licence subject to terms 3 and 5.
3. The licence may be revoked, suspended or modified at any time by the Controller of Water Resources (the Controller) as provided for in section 93 of the *Water Act*.
4. The licensee can surrender or apply for modification of the licence at any time.
5. Non use of the water entitlement conferred under the licence may result in full or partial revocation by the Controller.
6. If a Water Allocation Plan (WAP) has been declared for the stated Water Control District under section 22B of the *Water Act*, the licensed water entitlement may be able to be traded to another person in full or part, permanently or temporarily, subject to WAP rules.
7. Chemical and/or fertiliser injection systems shall not be installed into the pump discharge lines without the prior approval of the Controller.
8. No guarantee is given or implied by this licence that water will be available from the water resource at any given time.

**Conditions**

1. The water entitlement shown for each beneficial use must be used for no other purpose than that beneficial use, without approval of the Controller.
2. Pumpage for each month from all production bore(s) used to access water supplies associated with this licence shall be recorded by a meter supplied, installed and maintained by the licence holder to the satisfaction of the Controller;
3. The record of pumpage for each month must be supplied to the Controller within two weeks of the end of each reporting period as stated in the specific conditions of this licence.
4. The following specific conditions apply:
  - a. The production bores and monitoring bores must be drilled within twelve (12) months from the granting of this licence or the licence may be revoked;
  - b. Conductivity readings must be taken each six months for the above listed production bore(s);
  - c. The licence holder must maintain monthly standing water level readings as listed in the attached Schedule 'A';
  - d. The data from Condition 3, Special Condition b) and the attached Schedule 'A' shall be supplied to the Controller of Water Resources within two (2) weeks following the end of each month;
  - e. A sample of groundwater from one of the production bores used to access water supplies associated with this licence, shall be taken annually on a rotational basis for chemical analysis, including analysis for heavy metals. The results of the analysis shall be included in the annual statement;
  - f. The type and total area of each crop irrigated in each twelve (12) month period ending 30 June shall be reported in the annual statement;
  - g. The licensee shall prepare an annual statement, including information in b), e), f) and schedule 'A' to the Controller of Water Resources by the end of July each year.

I hereby agree to the terms and conditions as stated in this licence: (Please tick)

Applicants signature: ..... Date: .....

Controller of Water Resources: *Sean Linn* ..... Date: *28/08/2009*

## **Attachment 2: Neutral Junction Station Resource Management**

- 1 Grazing and pasture management plan (periods of stocking, stocking rates, spelling, fertilizer and woody regrowth management)**
  - a. The 81.44 hectare irrigated pasture is being establish to provide the maximum amount of hay from multiple annual cropping using fertilisers**
  - b. The paddock may be grazed by stock for short periods**
  - c. Any regrowth within the irrigated area will be cleared.**
  - d. It is expected that any excess fertilizer nutrients will be used by the windbreak trees and shrubs. The intention will be to maximise fertilizer use by the crop and minimize loss to surrounding areas.**
  - e. Woody regrowth over firebreaks will be slashed.**
  
- 2 Weed management plan**
  - a. There are no known Class A or Class B weed in the area**
  - b. Rubber bush (*Calotropis procera*) is growing on the Warrabri Land Trust property about 15 km to the east.**
  - c. If seedlings of Rubber bush or other Class A or Class B weeds appear within the cropping pasture paddock or adjacent areas then they will be cleared and the area pegged for any follow up treatment that may be necessary.**
  
- 3 Exotic Pasture Species Management Plan**
  - a. Within the paddock pasture species will be irrigated, these are unlikely to migrate outside the boundary fence due to the harsh conditions and normally lack of high rainfall in the area. A fire break is to be maintained around the boundary fence, this will further reduce the ability of the pasture species to spread into the buffer area and beyond.**
  - b. A tree and shrub wind break will be established around the cropping area this will further reduce spreading of the pasture species outside the fence.**
  - c. If infestation of the pasture species does occur outside the fences then measures will be implemented for its eradication/control.**
  - d. Buffel grass grows in Taylors floodout, along the Stuart Highway and in various areas of the property. It is believed that buffel grass has already spread to its most preferred habitats. Buffel grass is likely to establish within the pasture paddock with the increased water and nutrient levels. It will be controlled within the pasture area. It is unlikely to establish outside the boundary fence due to the low nutrient supply on the sand plain.**
  
- 4 Fire Management Plan**
  - a. Fire suppression will be undertaken in the pasture paddock.**

- b. A fire fighting unit and equipment will be located within the pasture paddock**
- c. Fire breaks will be maintained around the pasture paddock boundary fence and on the outer perimeter of the buffer area. Additional fire breaks will be maintained between the buffer area the northern property access track used by indigenous people hunting and travelling through to various communities and Taylors Creek floodout**
- d. Biomass and litter reduction will be managed within the buffer area by periodic burning on a long term patchwork quilt basis based on volumes of biomass, seasons, time of year and likely rainfall.**

**5 Native Vegetation Management plan (prevention of degradation to native vegetation, including vegetation buffers).**

- a. The native vegetation will be removed over an 82 hectare area for the irrigated pasture area and associated infrastructure.**
- b. Exotic tree windbreaks will be grown around the irrigated area amongst any existing native shrubs and trees. Additional plantings of native trees and shrubs will also be planted whilst these tend to be slow growing they will not need irrigation after establishment**
- c. The surrounding buffer area will be patchwork burned on an appropriate program to reduce fire hazard and as far as is possible replicate pre European burning patterns. This will reduce the undesirable impacts on this vegetation in this area from the excessive burning that has occurred in this paddock in recent years from fires lit by passing indigenous people.**
- d. The sand plain is not heavily grazed by stock due to the normal lack of suitable pasture species. Stock graze the grasses in Taylors Creek floodout and run-on areas of the Osborne Ranges and associated hills. Following rare high rainfall events parakelya grows on the sand plains**
- e. If the fodder paddock attracts large numbers of animals such as kangaroos which commence impacting on the vegetation within the buffer area surrounding the pasture paddock then remedial steps will be taken.**

**6 Native animal management plan**

- a. The pasture cropping irrigation areas will be fenced if necessary with high "pig" wire to exclude stock and large native animals e.g. wallabies and kangaroos. The boundary of the pasture paddocks will be fenced with standard barbed wire and star picket fences to exclude cattle and electrified.**
- b. A fire break and access track will be slashed around the boundary fence to provide a visual warning of the presence of the fence.**

- c. **The surrounding buffer area will be patchwork burned on an appropriate program to reduce fire hazard and as far as is possible replicate pre European burning patterns.**
- d. **If population of birds or small native animals explode within the fodder growing area then advice on the management will be sought from NRETAS experts.**

**7 Erosion and sediment control plan (erosion prevention and strategies for rehabilitation if erosion occurs)**

- a. **Within the paddock the clearing approach will adopt the approach setout in NRETAS clearing guidelines and brochures.**
- b. **The cleared and leveled irrigated cropping area will be revegetated with pastures as soon as is possible**
- c. **Similarly within the surrounding buffer zone and firebreaks and access tracks the approach will conform with that identified in NRETAS clearing guidelines and brochures.**
- d. **Care will be taken in the siting of the outer fire breaks and access track so that there is not continuous straight grading or wheel ruts (curve through the landscape) and any berms to be knocked down.**
- e. **The main access track will be sited at relatively small angle to the northern boundary access road but consistent with road safety issues.**
- f. **If necessary gravel / calcrete rubble will be placed over all or parts of the main access track. Whilst the area is fairly flat sandy and highly permeable the intention will be to avoid impacting on any surface runoff.**
- g. **The station has its own earth moving plant (dozer & graders etc) and will be purchasing tractors for use with the cropping area so will be able to undertake rehabilitation and remedial measures quickly if erosion does occur in this area. If erosion does occur then management will seek advice from NRETAS on rehabilitation and remedial measures.**

**8 Feral animal management plan**

- a. **There are few feral animal problems on the property. There are no rabbits, pigs, camels, donkeys or wild horses on the property. Feral cats occur as everywhere in Australia, foxes are very rarely sighted.**
- b. **The feral animal management plan for Neutral Junction is simply to shoot or remove feral animals where located.**

This is the Property Management Plan for Land Clearing Development referred to in Pastoral Land Clearing Permit No. PLC09/1 issued on 11/09/2009



CHAIRMAN  
PASTORAL LAND BOARD

# Drawing No. 09/969/1 NEUTRAL JUNCTION CLEARING PLAN NT Portion 3375 PPL 969

Total Application Area - 81 Ha

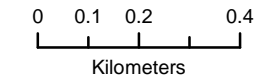

Map Grid of Australia (MGA) Zone 53  
Universal Transverse Mercator Projection  
Horizontal datum:  
Geocentric Datum of Australia (GDA) 1994

## Legend

- Bore or Well
- Turkey Nest
- clearing\_proposed
- Proposed\_development\_area
- Cadastre
- Cultural - Fenceline
- Hydro - Creek or River - Non Perennial
- Transport - Highway Sealed
- Transport - Vehicle Track
- Water - Pipeline

Location within Northern Alice Springs Pastoral District

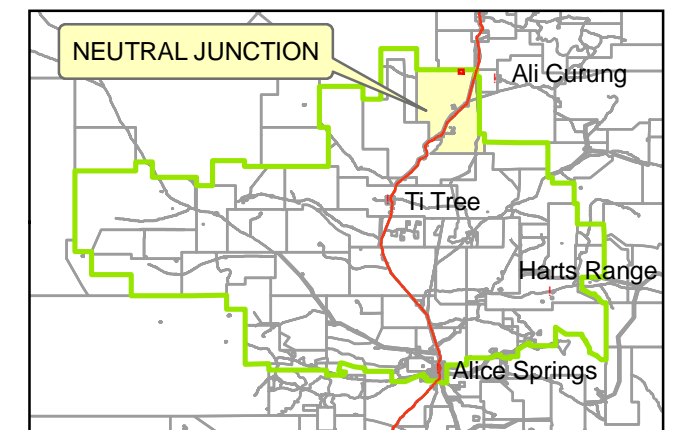

© Northern Territory of Australia, 2008

The Northern Territory of Australia does not warrant that the product or any part of it is correct or complete and will not be liable for any loss, damage or injury suffered by any person as a result of its inaccuracy or incompleteness. You are encouraged to notify any error or omission in the material by calling 8999 4754.

### DATA SOURCE

Property Infrastructure: Rangelands Management Branch, NRETAS  
(Infrastructure displayed on this map is current as at 22/07/2008)  
Clearing Area: Drawn by Rangelands Management Branch, Palmerston, N.T.  
(Clearing area supplied by Alice Springs NRETAS as GPS points)  
Cadastre: Land Information, Land Division, DPI, Darwin, N.T.

### For further information contact:

Rangeland Management Branch  
Department of Natural Resources, Environment, the Arts and Sport (NRETAS)  
3rd Floor, Goyder Centre, Palmerston, Northern Territory  
Phone: (08) 8999 4754, Fax: (08) 8999 4403

### Map details:

Map prepared by Rangelands Management, NRETAS, Palmerston  
Date: 02 June 2009. Plot File Reference: CLR\_NTJ\_09\_001.pdf

This is the drawing referred  
to in Pastoral Land Clearing

Permit No: PLC09/1  
Issued on: 11/09/2009

*Anthony Young*

CHAIRMAN, PASTORAL LAND BOARD

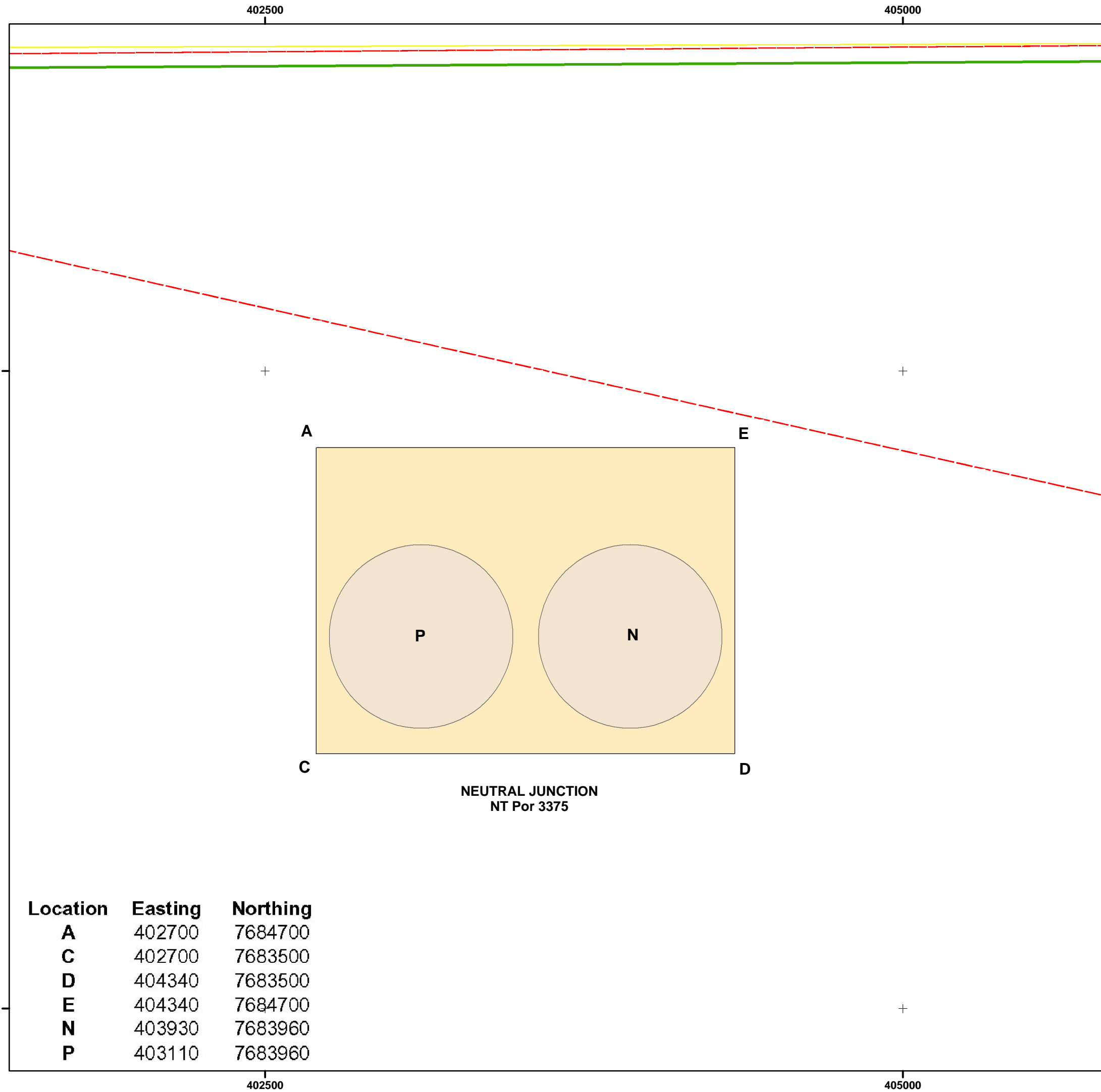

NEUTRAL JUNCTION  
NT Por 3375

Location	Easting	Northing
A	402700	7684700
C	402700	7683500
D	404340	7683500
E	404340	7684700
N	403930	7683960
P	403110	7683960