

NORTHERN TERRITORY OF AUSTRALIA

Planning Act

AMENDMENT OF NT PLANNING SCHEME

I, GERALD FRANCIS MCCARTHY, the Minister for Lands and Planning, under section 12(2)(a) of the *Planning Act*, amend the NT Planning Scheme by making the amendment specified in the Schedule.

Dated 1st January 2010
2009

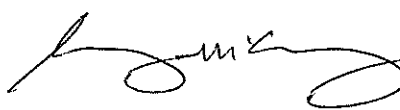
Minister for Lands and Planning

SCHEDULE

AMENDMENT OF NT PLANNING SCHEME

AMENDMENT No. 111

1. Citation

This amendment to the NT Planning Scheme may be cited as Amendment No. 111.

2. Definitions

In this amendment –

"amending map" means the map, signed by the Minister for Lands and Planning and marked "NT Planning Scheme Amendment No. 111", deposited in the office of the Department of Lands and Planning, Darwin;

"zoning map" means the zoning map within the meaning of the NT Planning Scheme.

3. Amendment of zoning map

The NT Planning Scheme is amended by:

- (a) amending the zoning map relating to Alice Springs to the extent of its inconsistency with the amending map in respect of the area of land shown on the amending map bounded by a thick black line and lettered "SU (5)" Specific Use, which is Lot 8132 (15) Len Kittle Drive, Town of Alice Springs, and

- (b) amending Schedule 1 to clause 2.4 – Specific Uses to include the following table:

SA5	<p>Lots 8132 (15) Len Kittle Drive, Town of Alice Springs.</p> <p>1. The purpose of this zone is to facilitate the use and development of the land for managed short term accommodation.</p> <p>2. Subject to paragraphs 3 to 5 (inclusive) and without consent the land may be developed for the purpose of:</p> <ul style="list-style-type: none">(a) caretaker's residence;(b) caravan park (including the use of demountable structures as cabins);(c) child care centre;(d) community centre;(e) hostel;(f) office;(g) shop;(h) sport and recreation; and(i) supporting accommodation <p>3. All buildings contain a single storey only.</p> <p>4. A use or development specified in paragraph 2 shall:</p> <ul style="list-style-type: none">(a) be setback a minimum of 9.0 metres from the Len Kittle Drive boundary and 3.0 metres from all other boundaries;(b) provide a minimum 3.0 metre wide planted landscape buffer to Len Kittle Drive; and(c) have all car parking screened from the street, and where car parking is not under cover, shade landscaping is to be incorporated into the design of the car parking areas. <p>5. A Mosquito Management Plan shall be prepared in consultation with the Department of Health and Families and the accommodation shall only operate while the Management Plan is active.</p> <p>6. Any other use or development or variation of the requirements in paragraphs 3 to 5 requires the consent of the consent authority.</p>
-----	---

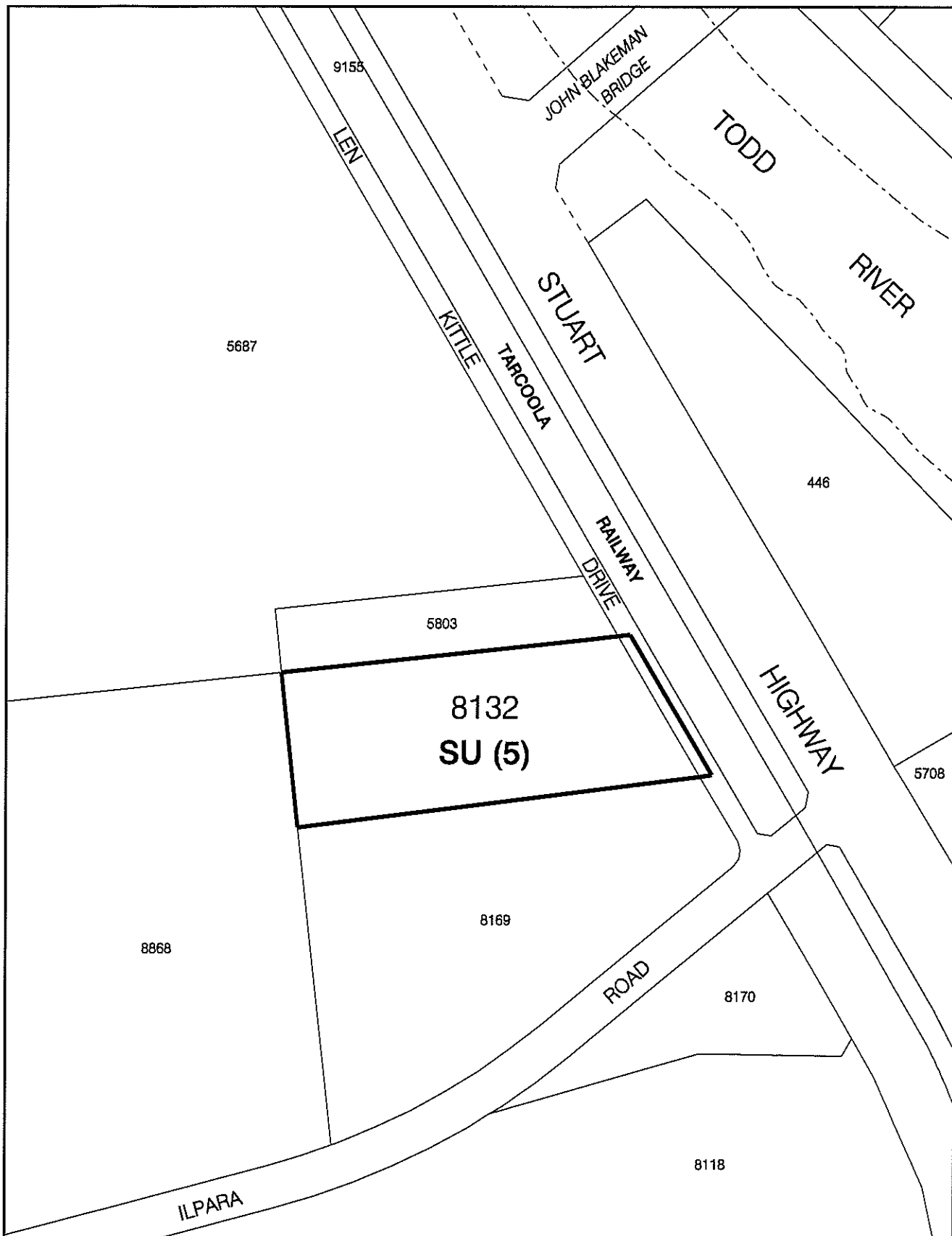

NT PLANNING SCHEME
 AMENDMENT No. 111
 LOT 8132 TOWN OF ALICE SPRINGS



Northern
 Territory
 Government

Department of Lands and Planning



Scale 1: 5000 @ A4



MINISTER FOR LANDS AND PLANNING

[Signature]

Date 1/1/2010

Date: 07/12/2009

Drawing Name:

lot 8132 dec 2009.dgn/pdf

X

NORTHERN TERRITORY OF AUSTRALIA

Planning Act

**NOTICE OF AMENDMENT OF NT PLANNING SCHEME
AMENDMENT No. 111**

I, GERALD FRANCIS MCCARTHY, the Minister for Lands and Planning, under section 28(1) of the *Planning Act*, give notice that -

- (a) I have amended the NT Planning Scheme by rezoning Lot 8132 (15) Len Kittle Drive, Town of Alice Springs to Zone SU (Specific Use); and
- (b) copies of the amendment are available from the Offices of the Department of Lands and Planning, Level 1, Alice Plaza, Todd Mall, Alice Springs.

Dated  ~~2009~~ 2010

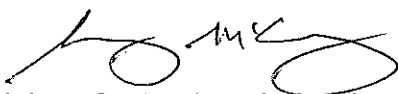
Minister for Lands and Planning

NORTHERN TERRITORY OF AUSTRALIA

Planning Act
Section 29

Reasons for Decision

NORTHERN TERRITORY PLANNING SCHEME AMENDMENT
AMENDMENT No. 111

The amendment will facilitate the establishment of managed short term visitor accommodation facility incorporating accommodation cabins, safari tents, a managed campground and community facilities with the refurbishment and reuse of existing buildings and the construction of additional buildings. The range of land uses permitted will provide for the necessary social, cultural, and recreational needs of residents.

The proposed use represents a major initiative to address a critical housing need for both visitors to town and for residents of town camps. The provision of short term accommodation is integral to the success of the Commonwealth sponsored SIHIP program which will see significant redevelopment and refurbishment of the camps.

The proposal is consistent with the Territory 2030 Target of:

Improving access to accommodation: by 2030 every Territorian will have access to appropriate accommodation.

Amendment No. 111 rezones Lot 8132 (15) Len Kittle Drive, Alice Springs to Zone SU (Specific Use).



GERALD FRANCIS MCCARTHY
Minister for Lands and Planning

| / | 2010
2009