

NOTICE OF MINERAL TITLE APPLICATIONS OVER ABORIGINAL LAND

MINERAL TITLES ACT 2010 SECTION 71

Objections/Submissions to Mineral Title applications (s71 [3])

The landowner(s) of land in respect of which the following applications are made may lodge an objection to the grant of the application; any other persons may lodge a submission. Objections and submissions must be lodged in writing to the Department of Industry, Tourism and Trade, GPO Box 4550, DARWIN NT 0801 or emailed to titles.info@nt.gov.au. Objections and submissions can also be lodged at Centrepoint Building, 48-50 Smith Street, Darwin, within 30 days from the relevant Notification Date, which is set out below.

Exploration Licence 33739 sought by GEMPART (NT) PTY LTD, ACN 081 859 896 over an area of 208 Blocks (663 km²) depicted below for a term of 6 years, within the SYDNEY MARGARET locality.

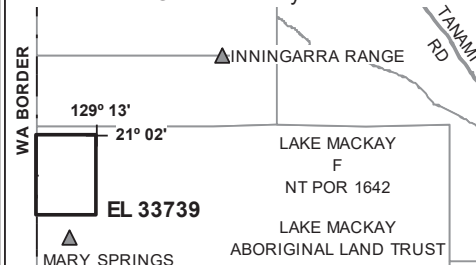

Not To Scale NMIG Map Sheet No: 4755

Exploration Licence 33769 sought by HQ-CO INVESTMENT PTY LTD, ACN 664 025 209 and WINDY HILLS EXPORT MEATS PTY LTD, ACN 631 458 832 over an area of 17 Blocks (30 km²) depicted below for a term of 6 years, within the BATHURST ISLAND locality.

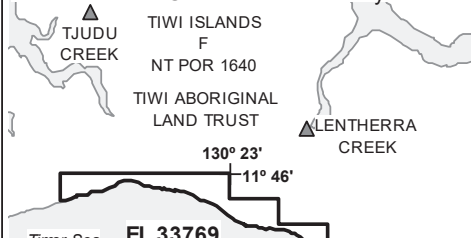

Not To Scale NMIG Map Sheet No: 4974

Exploration Licence 33794 sought by WA1 RESOURCES LTD, ACN 646 878 631 over an area of 78 Blocks (249 km²) depicted below for a term of 6 years, within the WARBURTON locality.

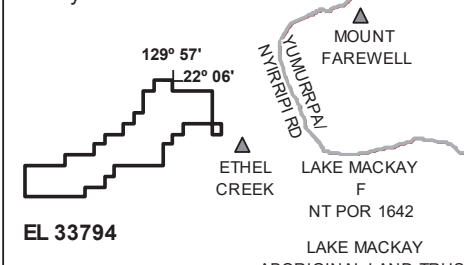

Not To Scale NMIG Map Sheet No: 4853

Exploration Licence 33795 sought by WA1 RESOURCES LTD, ACN 646 878 631 over an area of 50 Blocks (159 km²) depicted below for a term of 6 years, within the EGERTON locality.

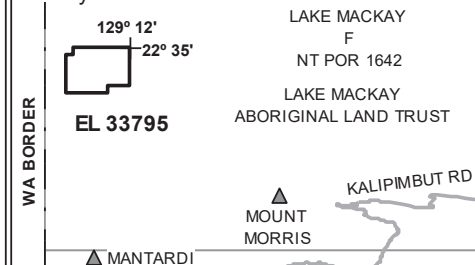

Not To Scale NMIG Map Sheet No: 4752

Exploration Licence 33796 sought by WA1 RESOURCES LTD, ACN 646 878 631 over an area of 243 Blocks (770 km²) depicted below for a term of 6 years, within the REDVERS locality.

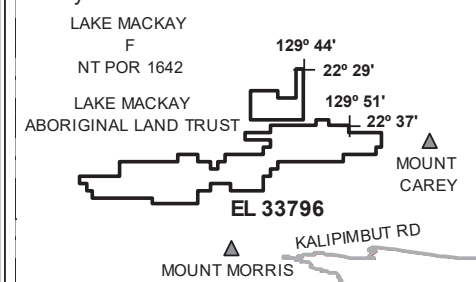

Not To Scale NMIG Map Sheet No: 4852

Exploration Licence 33797 sought by WA1 RESOURCES LTD, ACN 646 878 631 over an area of 4 Blocks (13 km²) depicted below for a term of 6 years, within the WARBURTON locality.

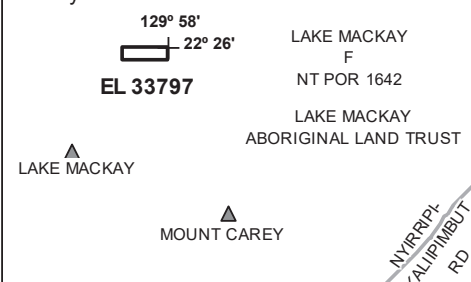

Not To Scale NMIG Map Sheet No: 4853

Exploration Licence 33808 sought by WA1 RESOURCES LTD, ACN 646 878 631 over an area of 181 Blocks (507 km²) depicted below for a term of 6 years, within the MOUNT PEAKE locality.

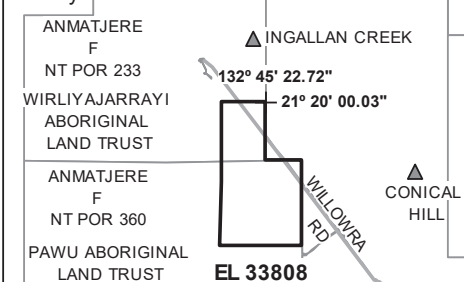

Not To Scale NMIG Map Sheet No: 5454

Exploration Licence 33809 sought by WA1 RESOURCES LTD, ACN 646 878 631 over an area of 207 Blocks (601 km²) depicted below for a term of 6 years, within the MOUNT PEAKE locality.

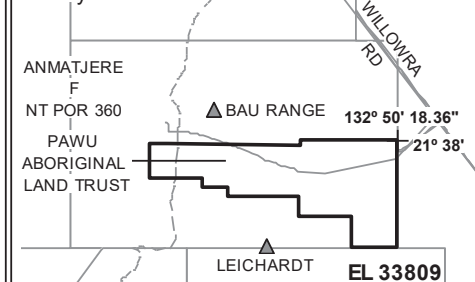

Not To Scale NMIG Map Sheet No: 5454

Notification Date: 1 May 2024