

NORTHERN TERRITORY OF AUSTRALIA

Planning Act

AMENDMENT TO NT PLANNING SCHEME

I, GERALD FRANCIS MCCARTHY, the Minister for Lands and Planning, under section 25(2)(a) of the *Planning Act*, amend the NT Planning Scheme by making the amendment, specified in the Schedule.

Dated 6th July 2010.

Minister for Lands and Planning

SCHEDULE

AMENDMENT TO NT PLANNING SCHEME

AMENDMENT No. 137

1. Citation

This amendment to the NT Planning Scheme may be cited as Amendment No. 137.

2. Definition

In this amendment –

"amending map" means the map, signed by the Minister for Lands and Planning and marked "NT Planning Scheme Amendment No. 137", deposited in the office of the Department of Lands and Planning, Darwin;

"zoning map" means the zoning map within the meaning of the NT Planning Scheme.

3. Amendment of Zoning Map

The NT Planning Scheme is amended by amending the zoning map relating to Namarada (Dundee Beach) to the extent of its inconsistency with the amending map in respect of the area of land shown on the amending map bounded by a thick black line and lettered OR (Organised Recreation) which is part Section 3084 (proposed Section 3909) Hundred of Glyde (500 Namarada Drive, Dundee Beach).

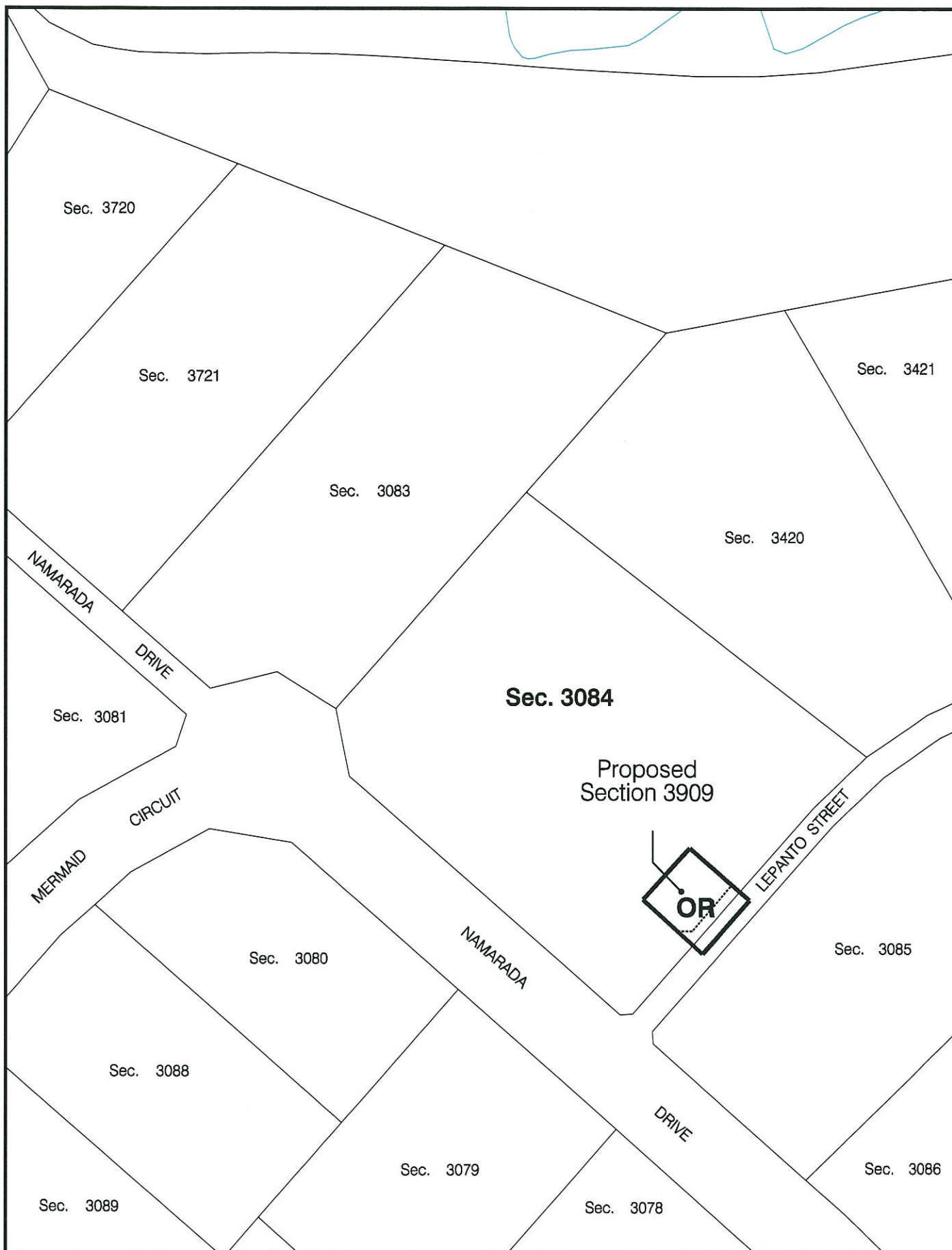

**NT PLANNING SCHEME
AMENDMENT No. 137
PART SECTION 3084
HUNDRED OF GLYDE**

MINISTER FOR LANDS AND PLANNING

[Signature]

Date *4/7/2010*



**Northern
Territory
Government**

Department of Lands & Planning



Scale 1: 6000 @ A4



File No. PA2010/0116

Date: 22-Jun-10

Drawing Name: Prop sec 3909 Glyde.dgn

NORTHERN TERRITORY OF AUSTRALIA

Planning Act

**NOTICE OF MAKING OF AMENDMENT TO NT PLANNING SCHEME
AMENDMENT No. 137**

DUNDEE BEACH LOCALITY

I, GERALD FRANCIS MCCARTHY, the Minister for Lands and Planning, under section 28(1) of the *Planning Act*, give notice that –

- (a) I have, under section 25 of the Act, amended the NT Planning Scheme by rezoning part Section 3084 (proposed Section 3909) Hundred of Glyde (500 Namarada Drive, Dundee Beach) from Zone CP (Community Purposes) to Zone OR (Organised Recreation); and
- (b) Copies of the amendment, (Amendment No. 137), are available from the Offices of the Department of Lands and Planning, Ground Floor, 38 Cavenagh Street, Darwin.

Dated

4th July

2010

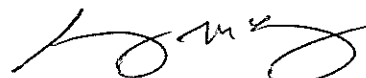

Minister for Lands and Planning

NORTHERN TERRITORY OF AUSTRALIA

Planning Act
Section 29

NT PLANNING SCHEME AMENDMENT

AMENDMENT No. 137

Reasons for Decision

The rezoning site, part Section 3084 (proposed Section 3909) Hundred of Glyde is located within the proposed Namarada Community Centre. The site is considered suitable for organised recreation and it will be compatible with the scale and character of surrounding development.



GERALD FRANCIS MCCARTHY
Minister for Lands and Planning

4 / 7 / 2010