

NORTHERN TERRITORY OF AUSTRALIA

Planning Act

AMENDMENT TO NT PLANNING SCHEME

I, EVA DINA LAWLER, Acting Minister for Infrastructure, Planning and Logistics, under section 25(2)(a) of the *Planning Act*, amend the NT Planning Scheme by making the amendment, specified in the Schedule.

Dated 28th May 2017.



Acting Minister for Infrastructure, Planning and Logistics

SCHEDULE

AMENDMENT TO NT PLANNING SCHEME

AMENDMENT No. 476

1. Citation

This amendment to the NT Planning Scheme may be cited as Amendment No. 476.

2. Definition

In this amendment –

"amending map" means the map, signed by the Minister for Infrastructure, Planning and Logistics and marked "NT Planning Scheme Amendment No. 476", deposited in the office of the Department of Infrastructure, Planning and Logistics, Darwin;

"zoning map" means the zoning map within the meaning of the NT Planning Scheme.

3. Amendment of Zoning Map

The NT Planning Scheme is amended by amending the zoning map relating to Katherine to the extent of its inconsistency with the amending map in respect of the area of land shown on the amending map bounded by a thick black line and lettered H which is NT Portion 5802 Emungalan.

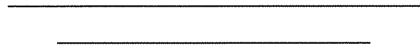

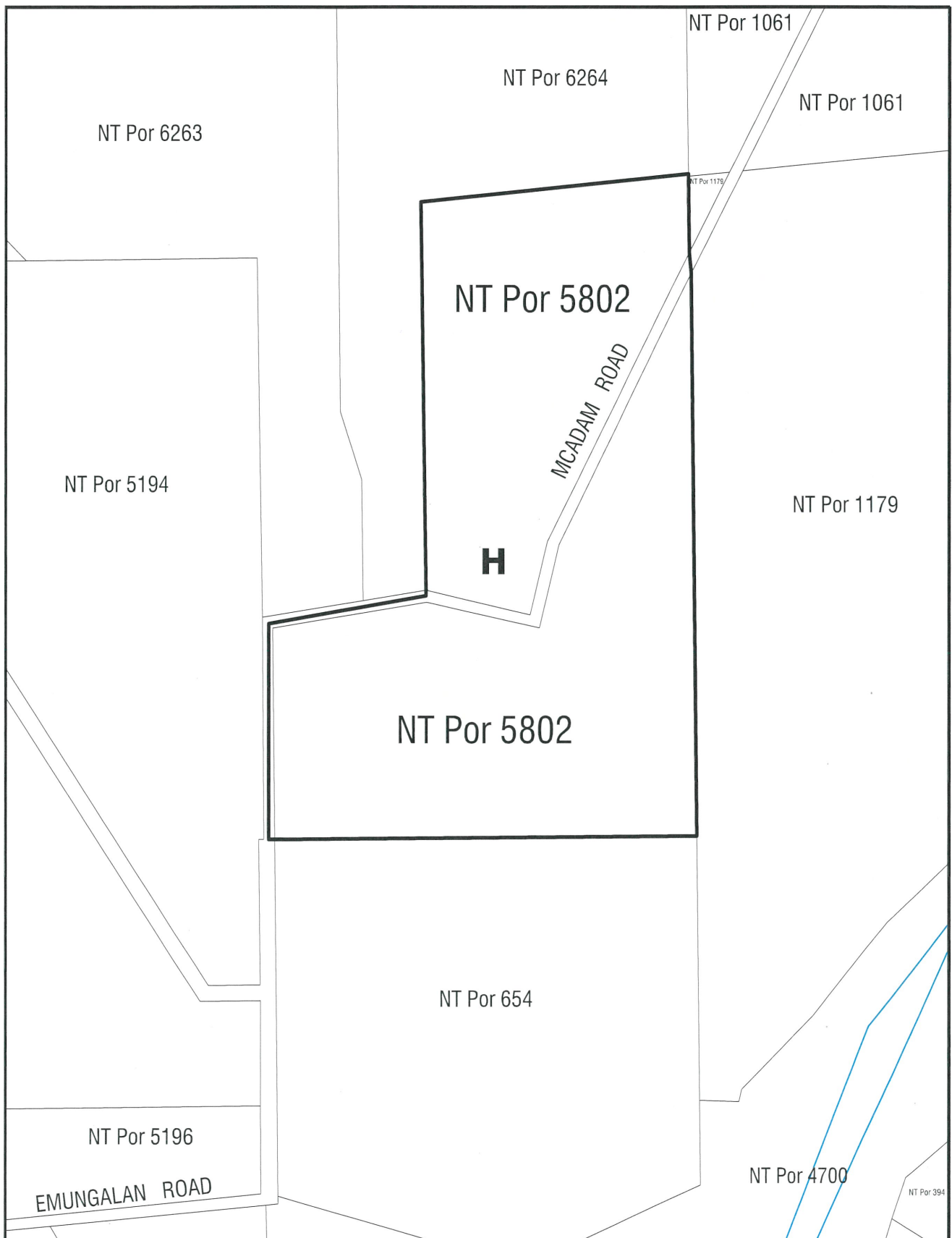

NT PLANNING SCHEME
AMENDMENT No. 476
NT PORTION 5802 EMUNGALAN



Department of Infrastructure, Planning and Logistics



Scale 1: 10000 @ A4



A/MINISTER FOR INFRASTRUCTURE, PLANNING AND LOGISTICS

Coastlaw

Date 28/5/17

File No. PA2016/0608

Date: 8-May-17

Drawing Name: PSA NT Por 5802.dgn

NORTHERN TERRITORY OF AUSTRALIA

Planning Act
Section 29

Reasons for Decision

NORTHERN TERRITORY PLANNING SCHEME

AMENDMENT No. 476

NT Portion 5802 of 70 McAdam Road Emungalan is suitable for rezoning from Zone A (Agriculture) to Zone H (Horticulture).

Specifically, this rezoning is suitable because:

- the combination of arable soils and proximity to a high yielding groundwater aquifer provides the opportunity for primary production;
- the site is adequately separated from sensitive uses that may be impacted by intensive horticulture activity;
- Zone H will prioritise the horticultural value of the land and limit the establishment of uses which are not compatible with this function; and
- in its current form, due to the lot size, configuration and alignment of a road reserve through the property, the land may be unsuitable for agriculture.



EVA LAWLER
Acting Minister for Infrastructure, Planning and Logistics

28/ 5 / 2017