

NT Por  
3869

# ELLIOTT BUILDING AREA (BBELL 001)

GURUNGU  
ELLIOTT NORTH CAMP

**GURUNGU  
ABORIGINAL LAND TRUST**

NT Por 3720

**Newcastle Waters**  
NT Por 2093

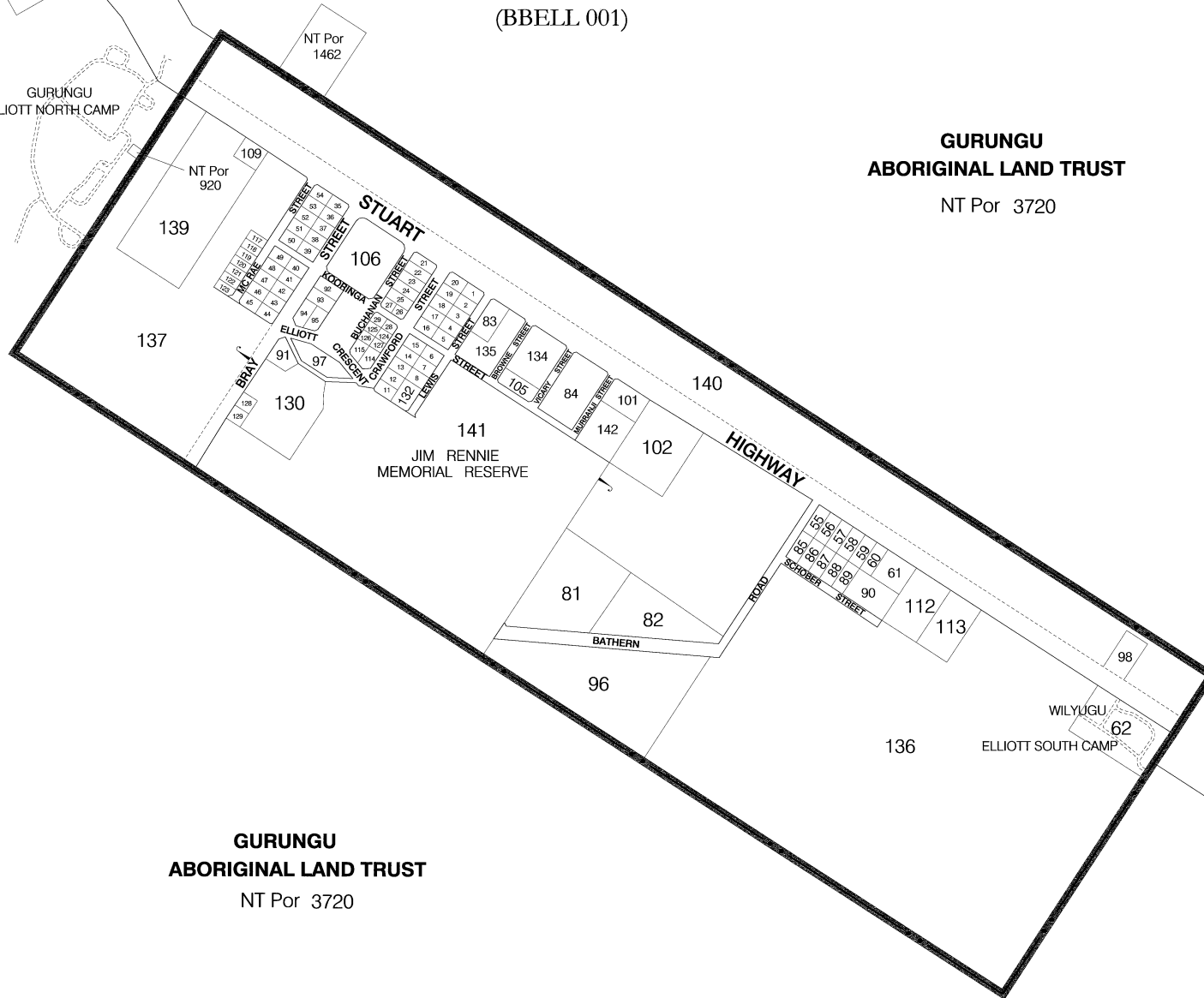

JIM RENNIE  
MEMORIAL RESERVE

**GURUNGU  
ABORIGINAL LAND TRUST**  
NT Por 3720

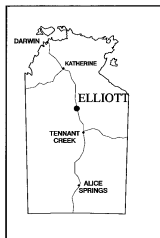

GDA  
Zone 53

*[Signature]*  
Minister for Lands and Planning  
Date: 10/9/04

**Town Boundary** ——— • • ———  
Northern Territory Government Gazette No. G34, 23 August 1950  
Northern Territory Government Gazette No. G50, 20 December 1989

**Building Area Boundary** ———

Cadastral Current as at 29/01/2004 Source: Northern Territory DCDB

The Northern Territory of Australia does not warrant that the product or any part of it is correct or complete and will not be liable for any loss, damage or injury suffered by any person as a result of its inaccuracy or incompleteness. You are encouraged to notify any error or omission in the material by calling 0899 7566.



**Northern Territory Government**  
Department of Infrastructure, Planning and Environment



**CP4960**