

# NOTICE OF MINERAL TITLE APPLICATIONS OVER ABORIGINAL LAND

*MINERAL TITLES ACT 2010 SECTION 71*

## Objections/Submissions to Mineral Title applications (s71 [3])

The landowner(s) of land in respect of which the following applications are made may lodge an objection to the grant of the application; any other persons may lodge a submission. Objections and submissions must be lodged in writing to the Department of Mining and Energy, GPO Box 4550, DARWIN NT 0801 or emailed to [titles.info@nt.gov.au](mailto:titles.info@nt.gov.au). Objections and submissions can also be lodged at Centrepont Building, 48-50 Smith Street, Darwin, within 30 days from the relevant Notification Date, which is set out below.

Exploration Licence 34094 sought by RIO TINTO EXPLORATION PTY LIMITED, ACN 000 057 125 over an area of 250 Blocks (802 km<sup>2</sup>) depicted below for a term of 6 years, within the STYLES locality.

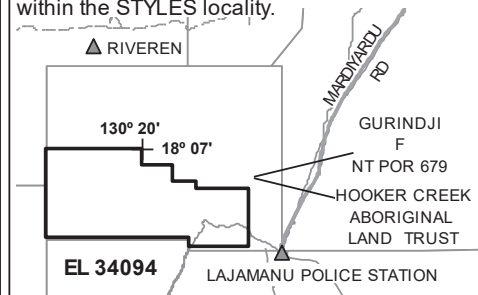

Not To Scale NMIG Map Sheet No: 4961

Exploration Licence 34095 sought by RIO TINTO EXPLORATION PTY LIMITED, ACN 000 057 125 over an area of 90 Blocks (294 km<sup>2</sup>) depicted below for a term of 6 years, within the STYLES locality.

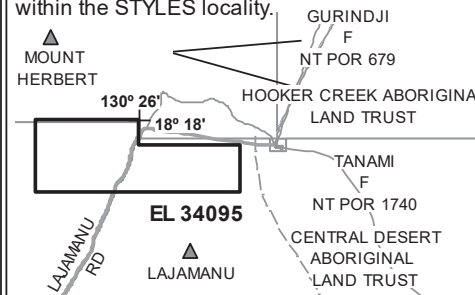

Not To Scale NMIG Map Sheet No: 4961

Exploration Licence 34096 sought by RIO TINTO EXPLORATION PTY LIMITED, ACN 000 057 125 over an area of 172 Blocks (548 km<sup>2</sup>) depicted below for a term of 6 years, within the STYLES locality.

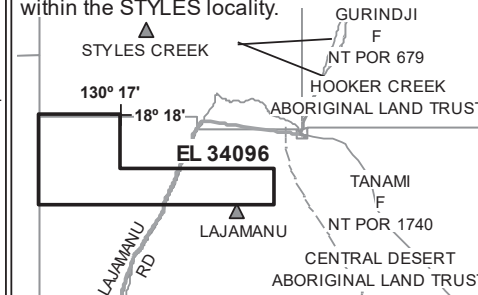

Not To Scale NMIG Map Sheet No: 4961

Exploration Licence 34097 sought by RIO TINTO EXPLORATION PTY LIMITED, ACN 000 057 125 over an area of 224 Blocks (719 km<sup>2</sup>) depicted below for a term of 6 years, within the MOUNT WINNECKE locality.

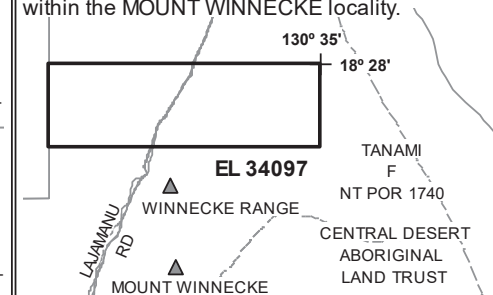

Not To Scale NMIG Map Sheet No: 4960

Exploration Licence 34098 sought by RIO TINTO EXPLORATION PTY LIMITED, ACN 000 057 125 over an area of 224 Blocks (723 km<sup>2</sup>) depicted below for a term of 6 years, within the MOUNT WINNECKE locality.

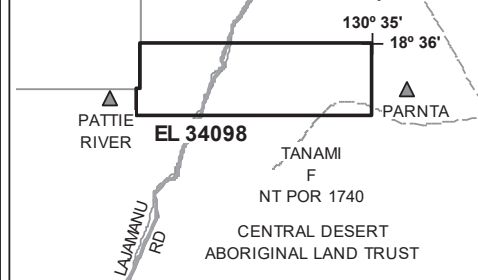

Not To Scale NMIG Map Sheet No: 4960

Exploration Licence 34099 sought by RIO TINTO EXPLORATION PTY LIMITED, ACN 000 057 125 over an area of 224 Blocks (729 km<sup>2</sup>) depicted below for a term of 6 years, within the MOUNT WINNECKE locality.

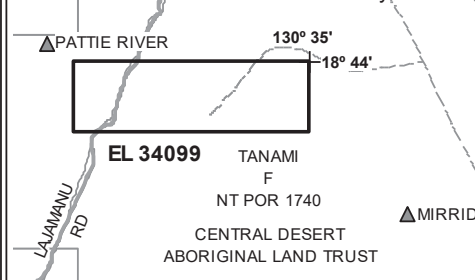

Not To Scale NMIG Map Sheet No: 4960

Exploration Licence 34100 sought by RIO TINTO EXPLORATION PTY LIMITED, ACN 000 057 125 over an area of 234 Blocks (761 km<sup>2</sup>) depicted below for a term of 6 years, within the MOUNT WINNECKE locality.

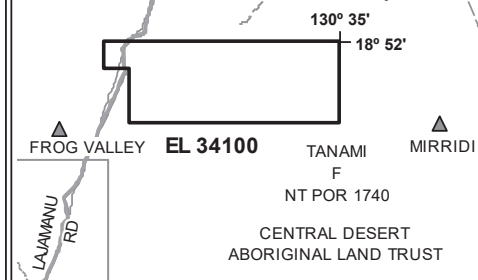

Not To Scale NMIG Map Sheet No: 4960

Exploration Licence 34101 sought by RIO TINTO EXPLORATION PTY LIMITED, ACN 000 057 125 over an area of 250 Blocks (812 km<sup>2</sup>) depicted below for a term of 6 years, within the WILSON CREEK locality.

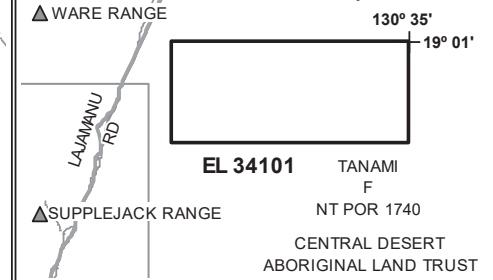

Not To Scale NMIG Map Sheet No: 4959

Exploration Licence 34102 sought by RIO TINTO EXPLORATION PTY LIMITED, ACN 000 057 125 over an area of 250 Blocks (811 km<sup>2</sup>) depicted below for a term of 6 years, within the WILSON CREEK locality.

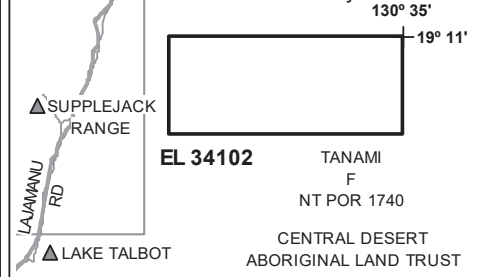

Not To Scale NMIG Map Sheet No: 4959

Exploration Licence 34103 sought by RIO TINTO EXPLORATION PTY LIMITED, ACN 000 057 125 over an area of 228 Blocks (717 km<sup>2</sup>) depicted below for a term of 6 years, within the WILSON CREEK locality.

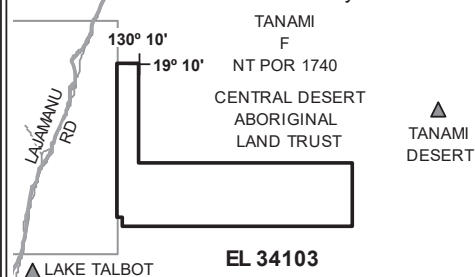

Not To Scale NMIG Map Sheet No: 4959

Notification Date: 14 May 2025