

NORTHERN TERRITORY OF AUSTRALIA

Planning Act 1999
Section 29

Reasons for Decision

NORTHERN TERRITORY PLANNING SCHEME
AMENDMENT No. 25

Pursuant to section 25(3)(b), I have decided to rezone Lot 1768 Town of Nightcliff from Zone LR (Low Density Residential) to Zone LMR (Low-Medium Residential) and approve minor consequential amendments to the Darwin Mid Suburbs Area Plan without further exhibition.

I have approved the amendment, as I am satisfied that, pursuant to section 25(2), the amendment:

- (a) promotes the purpose and objectives of the Act as it:
 - i. is consistent with the strategic framework;
 - ii. has been exhibited in line with the requirements of the Act;
 - iii. that the rezoning will facilitate additional public housing for the benefit of the community; and
 - iv. has Power and Water Corporation support for the increased demand on the existing infrastructure networks for power, water and sewer connections.

- (b) is consistent with the Compact Urban Growth Policy;

- (c) has merit and is in the public interest as it:
 - i. provides an appropriate density transition within Francis Street which is in keeping with the character of the area; and
 - ii. promotes the sustainable development of land which has convenient access to utility services, public transport, commercial, educational and community facilities.



EVA DINA LAWLER
Minister for Infrastructure, Planning and Logistics

17/ 11 / 2021

NORTHERN TERRITORY OF AUSTRALIA

Planning Act 1999

AMENDMENT TO NT PLANNING SCHEME 2020

I, EVA DINA LAWLER, Minister for Infrastructure, Planning and Logistics, under section 25(3)(b) of the *Planning Act 1999*, amend the NT Planning Scheme 2020 by making the amendment, specified in the Schedule.

Dated 17th NOVEMBER 2021.



Minister for Infrastructure, Planning and Logistics

SCHEDULE

AMENDMENT TO NT PLANNING SCHEME 2020

AMENDMENT No. 25

1. Citation

This amendment to the NT Planning Scheme 2020 may be cited as Amendment No. 25.

2. Definition

In this amendment –

"amending map" means the map, signed by the Minister for Infrastructure, Planning and Logistics and marked "NT Planning Scheme 2020 Amendment No. 25", deposited in the office of the Department of Infrastructure, Planning and Logistics, Darwin;

"zoning map" means the zoning map within the meaning of the NT Planning Scheme 2020.

"District Level Land Use Plan" & "Residential Areas Plan" means the relevant maps within the Darwin Mid-Suburbs Area Plan.

3. Amendment of Zoning Map

The NT Planning Scheme 2020 is amended by amending the zoning map relating to Darwin to the extent of its inconsistency with the amending map in respect of the area of land shown on the amending map bounded by a thick black line and lettered LMR which is Lot 1768 Town of Nightcliff.

4. Amendment of Darwin Mid-Suburbs Area Plan

Omit and replace the "District Level Land Use Plan" and "Residential Areas Plan" within the Darwin Mid-Suburbs Area Plan.

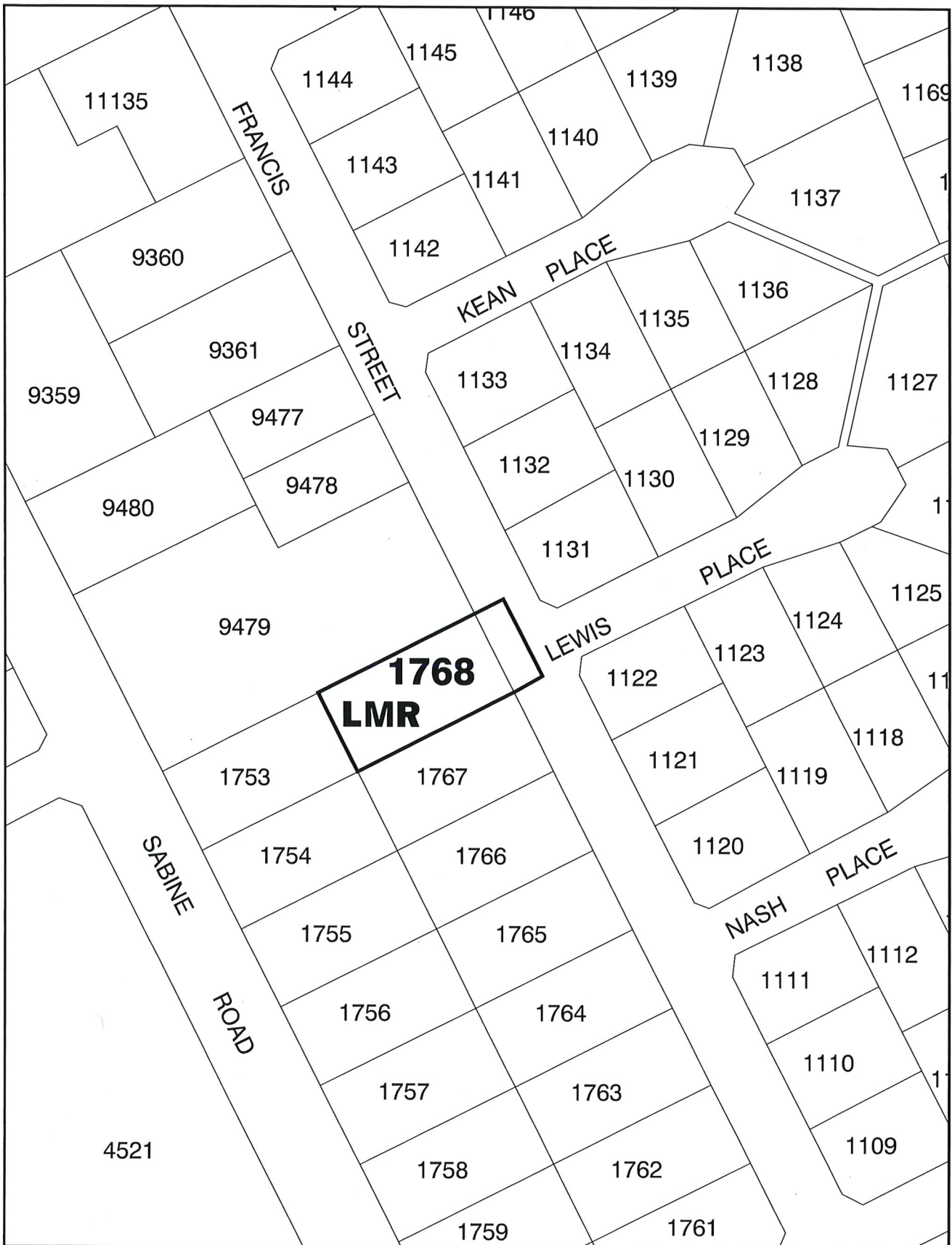

NT PLANNING SCHEME
 AMENDMENT No.25
 LOT 1768 TOWN OF NIGHTCLIFF



Department of Infrastructure, Planning and Logistics



Scale 1: 2000 @ A4



MINISTER FOR INFRASTRUCTURE, PLANNING AND LOGISTICS

Signature

Date 17/11/21

File No.: PA2019/0190

Date: 7-Nov-19

Drawing Name: PSA Lot 1768 Nightcliff.dgn